

DATE PLOTTED: 14 October 2021 1:32 PM BY: BO ZHENG

TBM LOCATION TABLE					
TBM No.	LOCATION	EASTING	NORTHING	TYPE	RL (AHD)
1	RESERVE	290102.40	5805809.04	STAR PICKET	41.05
2	LOT 313	290217.23	5805787.12	STAR PICKET	40.07
3	LOT 302	290285.75	5805892.53	STAR PICKET	40.58

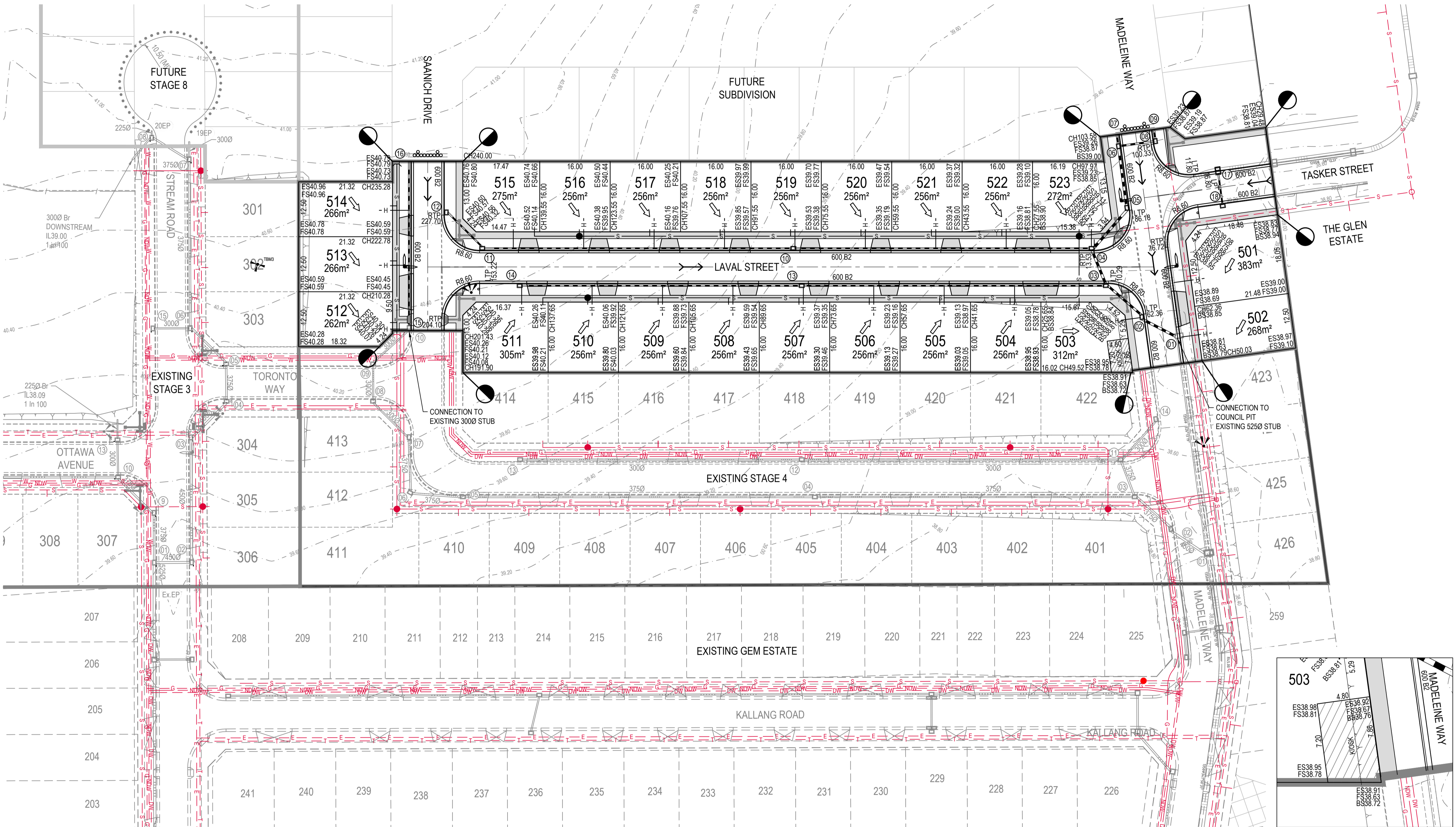

LEGEND	
	PERMANENT SURVEY MARK
	TEMPORARY BENCH MARK
	EXISTING SURFACE CONTOUR - MAJOR
	EXISTING SURFACE CONTOUR - MINOR
	FALL OF ALLOTMENT
	CENTRELINE OF ROAD
	EXISTING SURFACE LEVELS
	FINISHED SURFACE LEVELS
	BATTER SURFACE LEVELS
	RIDGE LEVELS
	PROPERTY INLET INVERT LEVEL
	KERB AND CHANNEL (AS SHOWN)
	STAGE BOUNDARY
	PROPOSED BATTER
	EXISTING TREE
	EXISTING TREE TO BE REMOVED
	EXISTING FEATURES TO BE REMOVED
	DIRECTIONAL HAZARD
	TACTILE GROUND SURFACE INDICATORS
	PROPOSED RESIDENTIAL VEHICLE CROSSING
	LIMIT OF WORKS
	"NO ROAD" SIGN AND BARRIER
	PROPOSED TRAFFIC SIGN
	PROPOSED STREET SIGN
	LINE-MARKING AND RRPMs
	PROPOSED STORMWATER DRAIN, PIT, DIAMETER AND PROPERTY INLET
	EXISTING STORMWATER DRAIN, PIT, DIAMETER AND PROPERTY INLET
	AG PROPOSED AGRICULTURAL DRAIN
	PIT NUMBER
	PROPOSED SWALE DRAIN
	OFFSET FROM BUILDING LINE
	PROPOSED SEWER, MAINT. STRUCTURES
	EXISTING SEWER, MAINT. STRUCTURES
	EXISTING WATER
	EXISTING GAS
	EXISTING ELECTRICITY
	EXISTING TELECOMMUNICATION
	EXISTING DRINKING WATER
	EXISTING NON-DRINKING WATER
	EXISTING WATER AND GAS CONDUIT
	VEHICLE CROSSING AND FOOTPATH
	PROPOSED TREE REFER TO LANDSCAPE PLAN BY LDA

WARNING
HIGH PRESSURE GAS MAINS IN CLOSE PROXIMITY

WARNING
BEWARE OF UNDERGROUND SERVICES
THE LOCATION OF UNDERGROUND SERVICES ARE APPROXIMATE ONLY AND THEIR EXACT POSITION SHOULD BE PROVEN ON SITE. NO GUARANTEE IS GIVEN THAT ALL EXISTING SERVICES ARE SHOWN.

CONTRACTOR TO VERIFY EXISTING SERVICES CONNECTION LEVELS PRIOR TO CONSTRUCTION. ANY DISCREPANCIES MUST BE IMMEDIATELY IDENTIFIED AND THE SUPERINTENDENT NOTIFIED PRIOR TO CONSTRUCTION COMMENCING.

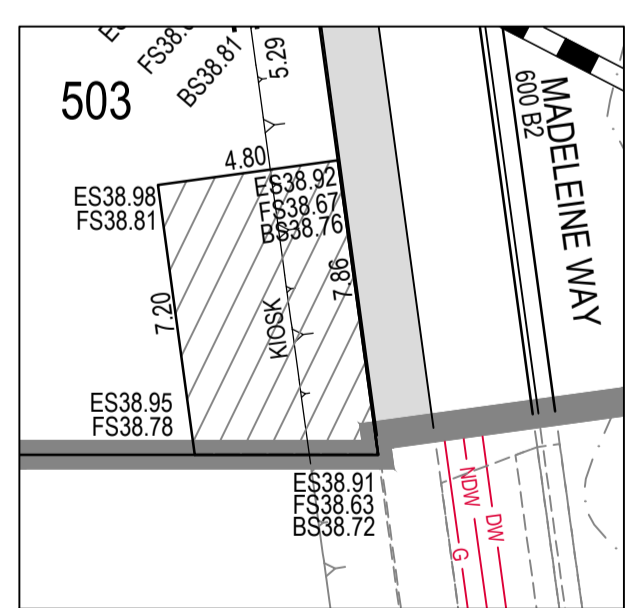

KIOSK ENLARGEMENT
SCALE 1:200

SCALE 1:200 @A1

WARNING
EXTERNAL APPROVAL
THIS DRAWING IS SUBJECT TO THE APPROVAL OF
WYNDHAM CITY COUNCIL
AND IS A PRELIMINARY ISSUE

COUNCIL REFERENCE
WYP9651/16

Rev.	Date	EXTERNAL ISSUE	Description	B.Z.	N.G.	N.G.
				Des.	Verf.	Appd.
1	15.10.2021	EXTERNAL ISSUE				

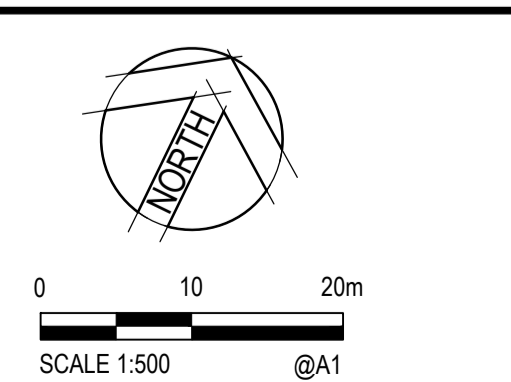

wes gault
www.wesgault.net.au
0408 692 443

gault+
projects through partnerships

© Cardno Limited All Rights Reserved.
This document is produced by Cardno Limited solely for the benefit of and use by the client in accordance with the terms of the retainer. Cardno Limited does not and shall not assume any responsibility or liability whatsoever to any third party arising out of any use or reliance by third party on the content of this document.

Cardno

Cardno Victoria Pty Ltd | ABN 47 106 610 913
Level 4, 501 Swanston Street
Melbourne VIC 3000
Tel: 03 8415 7777 Fax: 03 8415 7788
Web: www.cardno.com.au

Drawn	N.A.	Date	15.10.2021
Checked	B.Z.	Date	15.10.2021
Designed	B.Z.	Date	15.10.2021
Verified	N.G.	Date	
Approved		Date	
	N.G.		

Client **PARKLANE GARDENS DEVELOPMENT PTY LTD**

Project **PARKLANE GARDENS**
504-530 BALLAN ROAD, WYNDHAM VALE
WYNDHAM CITY COUNCIL

Title **CIVIL SITEWORKS**
DETAIL PLAN

Status	FOR EXTERNAL ISSUE		
	NOT TO BE USED FOR CONSTRUCTION PURPOSES		
Datum	Melway Ref	Scale	Size
A.H.D.	233 J12	1:500	A1
Drawing Number	V210357-5-CI-1050		Revision
			1