

DATE PLOTTED: 07/02/2019 10:55:00 AM BY: CARDNO

TBM LOCATION TABLE					
TBM No.	LOCATION	EASTING	NORTHING	TYPE	RL (AHD)
1	RESERVE No 1	290102.40	5805809.94	STAR PICKET	41.05
2	LOT 313	290217.23	5805787.12	STAR PICKET	40.07
3	LOT 302	290285.75	5805882.53	STAR PICKET	40.58

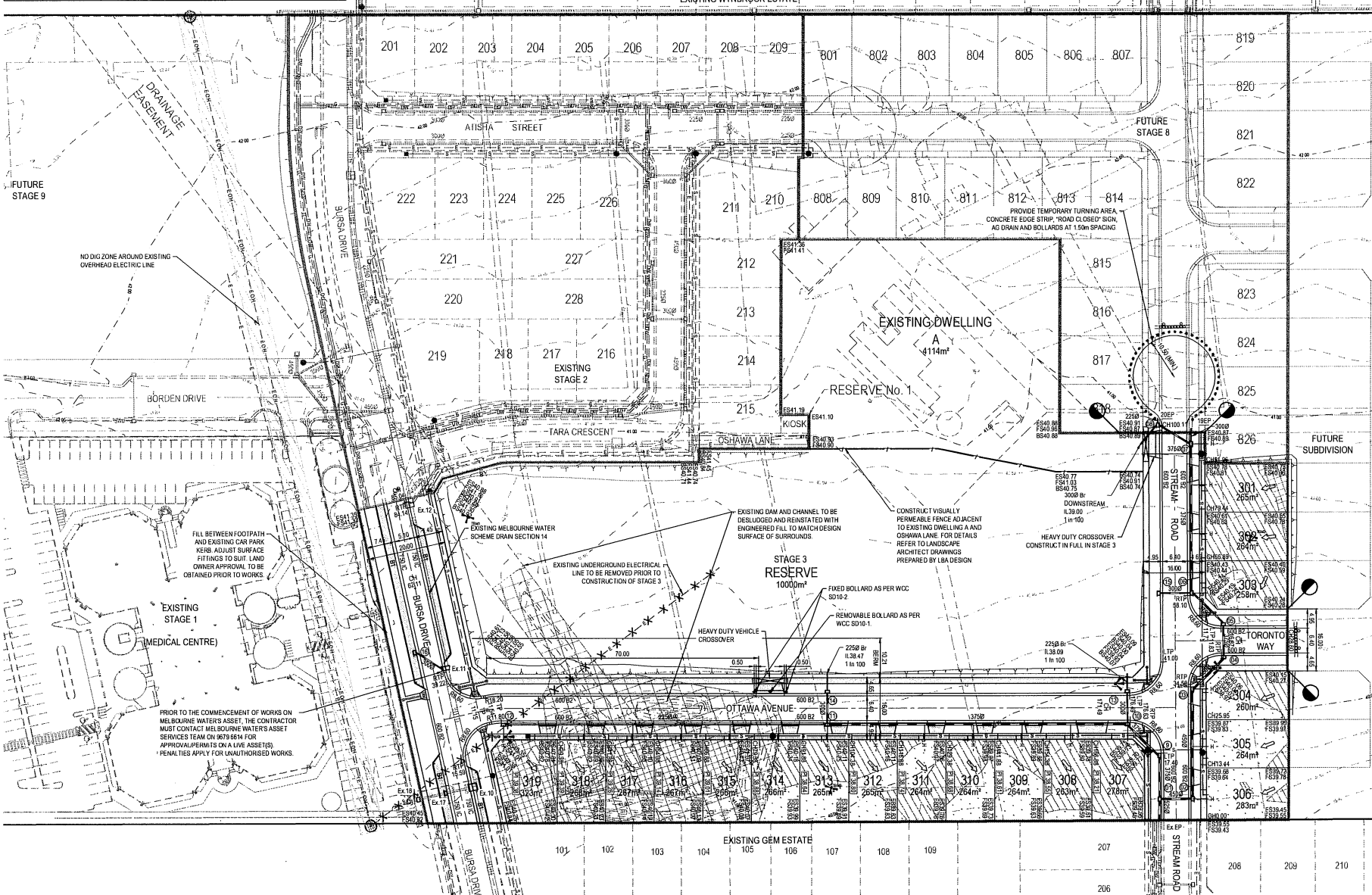

LEGEND

- PSM PERMANENT SURVEY MARK
- TBM TEMPORARY BENCH MARK
- EXISTING SURFACE CONTOUR - MAJOR
- EXISTING SURFACE CONTOUR - MINOR
- FALL OF SLOPEMENT
- CENTRELINE OF ROAD
- ES100.00 EXISTING SURFACE LEVELS
- FS100.00 FINISHED SURFACE LEVELS
- MS100.00 MATTER SURFACE LEVELS
- MS100.00 MOUSE LEVELS
- PS100.00 PROPOSED SURFACE LEVELS
- PROPOSED INVERT LEVEL
- KERB AND CHANNEL (AS SHOWN)
- PROPOSED RETAINING WALL
- VEHICLE EXCLUSION FENCE (BY OTHERS)
- PROPOSED 2000mm LOT LINE
- STAGE BOUNDARY
- PROPOSED BATTER
- EXISTING TREE
- EXISTING TREE TO BE REMOVED
- EXISTING FEATURES TO BE REMOVED
- TACTILE GROUND SURFACE INDICATORS
- PROPOSED INDUSTRIAL VEHICLE CROSSING
- PROPOSED RESIDENTIAL VEHICLE CROSSING
- LIMIT OF WORKS
- "NO ROAD" SIGN AND BARRIER
- PROPOSED TRAFFIC SIGN
- PROPOSED STREET SIGN
- LANDMARKING AND TIPS
- PROPOSED STORMWATER DRAIN, P.T. DIAMETER AND PROPERTY INLET
- EXISTING STORMWATER DRAIN, P.T. DIAMETER AND PROPERTY INLET
- PROPOSED MAIN DRAIN, P.T. AND DIAMETER
- PROPOSED AGRICULTURAL DRAIN, P.T. NUMBER
- PROPOSED SWALE DRAIN
- SOFFIT FROM UNDERGROUND
- PROPOSED SEWER MAIN STRUCTURES
- EXISTING SEWER MAIN STRUCTURES
- PROPOSED RISING MAIN
- EXISTING RISING MAIN
- EXISTING WATER
- EXISTING GAS
- EXISTING ELECTRICITY
- EXISTING TELECOMMUNICATION
- EXISTING DRINKING WATER
- EXISTING NON-DRINKING WATER
- EXISTING WATER AND GAS CONDUIT
- 15m RADII NO DIG ZONE AROUND EXISTING OVERHEAD ELECTRICAL POLES
- PARKING BAY
- VEHICLE CROSSING AND FOOTPATH
- SHARED PATH
- LANDSCAPING (BY OTHERS)
- INTERSECTION TREATMENT (SEGMENTAL PAVEMENT)
- LOT GRADING (OUT)
- LOT GRADING (FILL LESS THAN 200mm DEEP)
- LOT GRADING (FILL GREATER THAN 200mm DEEP)

WARNING

BEWARE OF UNDERGROUND SERVICES
THE LOCATION OF UNDERGROUND SERVICES ARE APPROXIMATE ONLY AND THEIR EXACT POSITION SHOULD BE PROVIDED ON SITE. NO GUARANTEE IS GIVEN THAT ALL EXISTING SERVICES ARE SHOWN.

CONTRACTOR TO VERIFY EXISTING SERVICES CONNECTION LEVELS PRIOR TO CONSTRUCTION. ANY DISCREPANCIES MUST BE IMMEDIATELY IDENTIFIED AND THE SUPERINTENDENT NOTIFIED PRIOR TO CONSTRUCTION COMMENCING.

FEATURE AND LEVEL SURVEY REF 88510142 RECEIVED 18 JULY 2018 PREPARED BY PEYTON WAITE PTY LTD IS INCOMPLETE. SOUTH EAST CORNER OF THE SITE NOT SURVEYED. CURRENTLY FENCED OFF FOR CONSTRUCTION OF THE EAST OUTFALL SEWER AND DRAINAGE.

EXTEND DRAINAGE 1.0m PAST STAGE BOUNDARY UNLESS OTHERWISE NOTED.

COUNCIL REFERENCE WYP965316

Rev	Date	Description	Des.	Verif.	Appd.
B	07.02.2019	CONSTRUCTION ISSUE	SH	SW	N.G.
A	30.01.2019	CONSTRUCTION ISSUE	SH	SW	N.G.

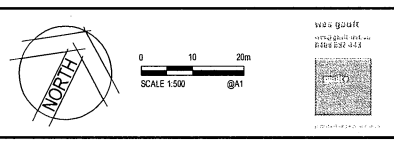

© Cardno Limited All Rights Reserved.
This document is produced by Cardno Limited solely for the benefit of and use by the client in accordance with the terms of the retainer. Cardno Limited does not and shall not assume any responsibility or liability whatsoever to any third party arising out of any use or reliance by third party on the content of this document.

Cardno
Shaping the Future

Cardno Victoria Pty Ltd | ABN 47 106 610 913
Level 4, 501 Swanton Street
Melbourne VIC 3000
Tel. 03 8415 7777 Fax: 03 8415 1788
Web: www.cardno.com.au

Drawn	N. GLASSON	Date	07.02.2019	Client	PARKLANE GARDENS DEVELOPMENT PTY LTD
Checked		Date		Project	PARKLANE GARDENS - STAGE 3
Designed		Date			504-530 BALLAN ROAD, WYNDHAM VALE
Verified		Date			WYNDHAM CITY COUNCIL
Approved		Date		Title	CIVIL SITEWORKS
					DETAIL PLAN

Status				FOR CONSTRUCTION	
Datum	AHD	Malways Ref	233 J12	Scale	1:500
Drawing Number	V171855-3-CI-1050		Size	A1	Revision
					B

C:\p\p\171855-3-CI-1050.dwg 30/01/2019 10:55:00 AM BY: CARDNO