

DATE PLOTTED: 11 April 2025 9:53 AM BY: JENSEN | AIRR

ITEM	ASPECT	REMARKS
------	--------	---------

EXISTING SERVICES ARE SHOWN ON THE PLANS. CONTRACTOR SHALL TAKE ALL NECESSARY MEASURES TO PROVE ALL EXISTING SERVICES PRIOR TO COMMENCING WORKS. THE LOCATION OF EXISTING SERVICES HAS BEEN OBTAINED FROM THE AVAILABLE AUTHORITY RECORDS. NO GUARANTEE IS GIVEN AS TO THE ADEQUACY OF THE SERVICES INFORMATION. SPECIAL NOTIFICATION SHALL BE GIVEN TO THE RELEVANT AUTHORITIES PRIOR TO THE COMMENCEMENT OF WORKS IN PROXIMITY TO TRANSMISSION ELECTRICITY LINES, TRANSMISSION GAS PIPES AND LARGE WATER MAINS.

THE CONTRACTOR SHALL ALLOW FOR THE RELOCATION OF SERVICES WITHIN THEIR WORKS PROGRAMME AND SHALL LIAISE WITH THE RELEVANT SERVICES AUTHORITIES AS NECESSARY TO ENSURE THAT THE RELOCATION WORKS ARE PROGRAMMED TO SUIT.

THE ALIGNMENTS AND OFFSETS OF PROPOSED SERVICES ARE SHOWN ON DRAWING V210926-6-CI-1100. FOR DETAILS OF PROPOSED SEWER AND WATER RETICULATION REFER TO CARNOO DRAWINGS AND AUTHORITY DRAWINGS. FOR DETAILS OF PROPOSED ELECTRICAL SERVICES REFER TO THE RETICULATED POWER/CO APPROVED DRAWINGS. FOR DETAILS OF OPTIC FIBRE SERVICES REFER TO NBN APPROVED DRAWINGS. FOR DETAILS OF GAS RETICULATION REFER TO AUSNET APPROVED DRAWINGS. SERVICE TRENCHES LOCATED UNDER PROPOSED PAVEMENTS INCLUDING VEHICLE CROSSINGS AND FOOTPATHS SHALL BE BACKFILLED WITH COMPACTED CLASS 2 FCR. TRENCHES ENCRoACHING UNDER ROAD PAVEMENT SHALL BE BACKFILLED WITH APPROVED GRANULAR MATERIAL TO THE SPECIFIED COMPOSITION AND COMPACTION OF THE ROAD PAVEMENT.

SERVICE CONDUITS SHALL BE INSTALLED AT THE LOCATIONS SHOWN ON RELEVANT DRAWINGS AT A MINIMUM COVER OF 600mm BELOW ROAD PAVEMENT LEVEL. SHARED WATER SERVICES CONDUITS SHALL BE 100mm DIAMETER CLASS 12 UPVC AND GAS CONDUITS 50mm CLASS 12. UNLESS SHOWN OTHERWISE, ELECTRICAL AND OPTIC FIBRE CONDUITS SHALL BE AS PER AUTHORITY DRAWINGS. GAS AND WATER CONDUITS SHALL EXTEND BENEATH THE FOOTPATH TO THE PROPERTY LINE. THE LOCATION OF ALL SERVICE CONDUITS SHALL BE MARKED CLEARLY ON THE KERB. AT LOCATIONS WHERE CONDUITS ARE NOT AT RIGHT ANGLES TO THE KERB, THEIR LOCATION SHALL BE MARKED ON BOTH SIDES OF THE ROAD.

ALL PIPES TO BE REINFORCED CONCRETE CLASS 2. PIPES UP TO 7500 SHALL BE RUBBER RING JOINTED. PIPES ABOVE THIS SIZE SHALL BE FLUSH JOINTED WITH EXTERNAL SEALING BANDS. DEVIATION AT THE JOINTS USED IN SUCH PIPES SHALL NOT EXCEED THE MANUFACTURER'S SPECIFICATIONS. PIPES UNDER PAVEMENTS AND DIRECTLY BEHIND KERBS SHALL BE BACKFILLED WITH CLASS 2 FCR AS DETAILED. WHERE ANY TRENCH ENCROACHES UNDER ROADWAYS, APPROVED FINE CRUSHED ROCK BACKFILL IS TO BE PROVIDED UNDER PAVEMENT AND IS TO BE COMPACTED TO THE SPECIFIED COMPACTION OF THE PAVEMENT.

100mm DIAMETER CLASS 400 PERFORATED PVC SUBSURFACE DRAINS SHALL BE INSTALLED BEHIND KERBS AND ELSEWHERE AS DETAILED ON EDCM. SUBSURFACE DRAINS SHALL OUTLET TO PITS AND UNDERGROUND DRAINAGE AS NECESSARY. AG DRAINS TO HAVE APPROVED BACKFILL. FLUSHOUT RISERS SHALL BE PROVIDED AT THE COMMENCEMENT OF EACH RUN OF DRAIN, AT INTERVALS OF BETWEEN 100m AND 150m ALONG THE DRAINAGE RUN TO BE LOCATED AT REAR OF KERB. REFER TO VPA ENGINEERING MANUAL STANDARD DRAWINGS.

AS PER VPA ENGINEERING MANUAL, SECTION 13.21 ALL LOTS SHALL BE PROVIDED WITH HOUSE DRAINS OR PROPERTY INLETS AS DETAILED. THE CONNECTION (LEGAL POINT OF DISCHARGE) POINTS ARE TO BE PROVIDED AT 5.5m FROM THE LOWEST CORNER OF EACH PROPERTY UNLESS NOTED OTHERWISE. PROPERTY INLETS ARE TO BE PROVIDED 1.0m FROM THE LOWEST CORNER OF THE BOUNDARY OR EASEMENT UNLESS NOTED OTHERWISE. REFER VPA ENGINEERING MANUAL, EDCM 701, 702, 703 AND 704.

ALL WORK SHALL BE CARRIED OUT IN ACCORDANCE WITH THE SPECIFICATIONS AND TO THE SATISFACTION OF THE ENGINEER AND ALL OTHER RELEVANT PARTIES. THE ENGINEER WILL CARRY OUT REGULAR SITE INSPECTIONS. ADDITIONAL INSPECTIONS CAN BE REQUESTED AT 24 HOURS NOTICE. ALL WORK TO BE CARRIED OUT IN ACCORDANCE WITH THE CURRENT VPA ENGINEERING MANUAL TECHNICAL SPECIFICATION, STANDARD DRAWINGS, APPROVED PROJECT SPECIFICATION AND TO THE SATISFACTION OF THE MANAGER, TECHNICAL SERVICES OR HIS/HER APPROVED REPRESENTATIVE.

ALL WORKS WILL BE SUPERVISED SEPARATELY BY THE CITY OF WYNDHAM'S CONSTRUCTION ENGINEER AND SHALL BE CARRIED OUT TO COUNCIL'S STANDARDS AND SATISFACTION. THE CONTRACTOR SHALL NOTIFY WYNDHAM CITY COUNCIL 7 DAYS PRIOR TO COMMENCEMENT OF WORKS. WORKS MAY NOT COMMENCE WITHOUT COUNCIL APPROVAL. ALL WORKS ARE TO BE COMPLETED PRIOR TO THE COMMENCEMENT OF THE MAINTENANCE PERIOD.

RESIDENTIAL FOOTPATHS TO BE 125mm DEPTH REINFORCED (SL72) CONCRETE ON 50mm FCR BEDDING. INDUSTRIAL/COMMERCIAL FOOTPATHS TO BE 150mm DEPTH REINFORCED (SL72) CONCRETE ON 50mm FCR BEDDING. THE BACK OF FOOTPATH IS TO BE OFFSET 50mm FROM THE ABUTTING TITLE BOUNDARY. VEHICLE CROSSINGS SHALL BE CONSTRUCTED IN ACCORDANCE WITH VPA ENGINEERING MANUAL, EDM 501, 502 AND 503. UNLESS NOTED OTHERWISE, TYPICALLY AT AN OFFSET OF 0.75m FROM THE SIDE BOUNDARY OF PROPERTIES UNLESS NOTED OTHERWISE.

FOR DETAILS OF LANDSCAPE WORKS REFER TO DRAWINGS PREPARED BY LBA DESIGN PTY LTD.

LOCATIONS OF STREET SIGNS SHOWN ARE NOMINAL ONLY AND SHALL BE CONFIRMED PRIOR TO INSTALLATION. SIGN AND POLE DETAILS ARE TO BE IN ACCORDANCE WITH THE VPA ENGINEERING MANUAL, SECTION 16.11.

UPON COMPLETION OF THE CIVIL WORKS, THE CONTRACTOR SHALL PROVIDE AS CONSTRUCTED PLANS TO VPA ENGINEERING MANUAL, SECTION 9.30 REQUIREMENTS INCLUDING D SPEC DIGITAL FORMAT AND AS NOTED ON THE PLANNING PERMIT.

TEMPORARY LINEMARKING (NORMAL PAINT) IS TO BE CARRIED OUT PRIOR TO THE START OF THE MAINTENANCE PERIOD. TEMPORARY LINEMARKING TO BE INSTALLED AND MAINTAINED UNTIL PERMANENT LINEMARKING IS INSTALLED ON THE WEARING COURSE ASPHALT. RRPMS ARE TO BE INSTALLED ONCE THE BASE COURSE ASPHALT IS PLACED AND MAINTAINED UNTIL PERMANENT RRPMS ARE INSTALLED ON THE WEARING COURSE ASPHALT. PERMANENT LINEMARKING (LONG LIFE PAINT) AND RRPMS (AT NOMINATED SPACINGS) ARE TO BE INSTALLED FOLLOWING THE INSTALLATION OF THE WEARING COURSE. THE INSTALLATION OF ALL LINEMARKING AND RRPMS IS TO BE IN ACCORDANCE WITH THE RELEVANT SPECIFICATIONS. ALL LINE MARKING, ADVISORY SIGNS AND FIRE HYDRANT MARKERS ARE TO BE INSTALLED PRIOR TO THE WORKS BEING OPEN FOR PUBLIC USE.

'NO ROAD' SIGNS AT THE EXTENTS OF ROADWORKS ARE TO BE INSTALLED ON A POST AND RAIL BARRIER EXTENDING BETWEEN BACKS OF KERBS. A CONCRETE EDGE STRIP SHALL BE CONSTRUCTED BETWEEN THE KERBS WITH A TEMPORARY AGRICULTURAL DRAIN BEHIND IT.

ALL WORKS MUST BE CARRIED OUT IN ACCORDANCE WITH VPA ENGINEERING MANUAL, CURRENT STANDARD DRAWINGS AND SPECIFICATIONS AND AS4000 CONDITIONS OF CONTRACT.



COUNCIL REFERENCE
WYP9651/16

wes gault
wes@gault.net.au
0408 692 443

gault+

projects through parkwork

© Cardno Limited All Rights Reserved.
This document is produced by Cardno Limited solely for the benefit of and use by the client in accordance with the terms of the retainer. Cardno Limited does not and shall not assume any responsibility or liability whatsoever to any third party arising out of any use or reliance by third party on the content of this document.



Client	PARKLANE GARDENS DEVELOPMENT PTY LTD	
Project	PARKLANE GARDENS - STAGE 6 504-530 BALLAN ROAD, WYNDHAM VALE WYNDHAM CITY COUNCIL	Status
Title	CIVIL SITEWORKS GENERAL NOTES, LOCALITY PLAN AND DRAWING REGISTER	A-H Drawing

Status				AS CONSTRUCTED	
Datum		Midway Ref	Scale	Size	A1
A.H.D.		233 J12	N.T.S.		
Drawing Number				Revision	
V210926-6-CI-1000				B	

TBM No.	LOCATION	EASTING	NORTHING	TYPE	RL (AHD)
1	RESERVE	290102.40	5805809.04	STAR PICKET	41.05
2	LOT 313	290217.23	5805787.12	STAR PICKET	40.07
3	LOT 302	290285.75	5805892.53	STAR PICKET	40.58

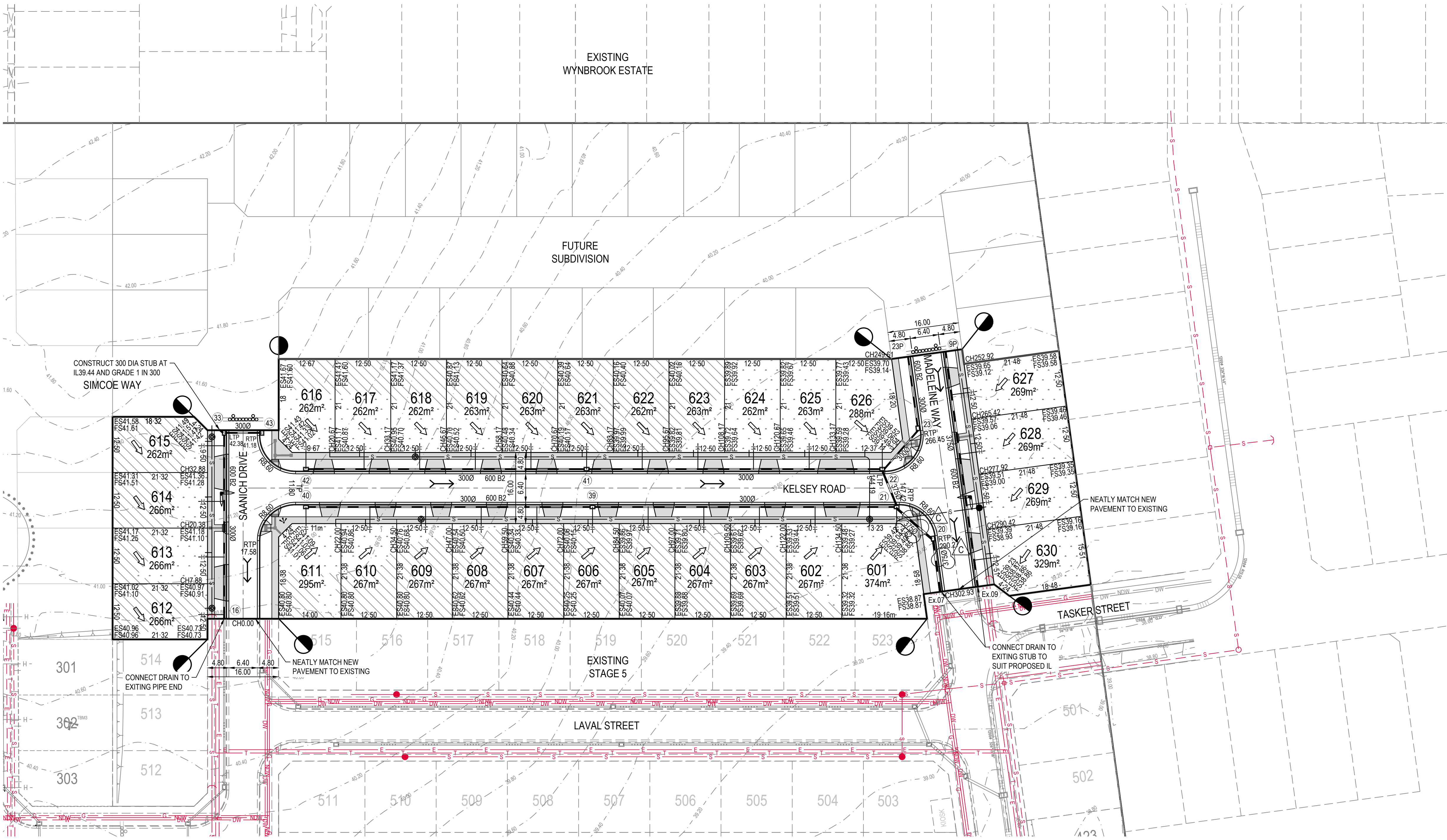

LEGEND	
	PERMANENT SURVEY MARK
	TEMPORARY BENCH MARK
	EXISTING SURFACE CONTOUR - MAJOR
	EXISTING SURFACE CONTOUR - MINOR
	FALL OF ALLOTMENT
	CENTRELINE OF ROAD
ES100.00	EXISTING SURFACE LEVELS
FS100.00	FINISHED SURFACE LEVELS
BS100.00	BATTER SURFACE LEVELS
R100.00	RIDGE LEVELS
PI100.00	PROPERTY INLET INVERT LEVEL
	KERB AND CHANNEL (AS SHOWN)
	STAGE BOUNDARY
	PROPOSED BATTER
	EXISTING TREE
	EXISTING TREE TO BE REMOVED
	EXISTING FEATURES TO BE REMOVED
	TACTILE GROUND SURFACE INDICATORS
	PROPOSED RESIDENTIAL VEHICLE CROSSING
	LIMIT OF WORKS
	"NO ROAD" SIGN AND BARRIER
	PROPOSED TRAFFIC SIGN
	PROPOSED STREET SIGN
	LINEMARKING AND RRPMS
	PROPOSED STORMWATER DRAIN, PIT, DIAMETER AND PROPERTY INLET
	EXISTING STORMWATER DRAIN, PIT, DIAMETER AND PROPERTY INLET
	PROPOSED AGRICULTURAL DRAIN
	PIT NUMBER
	PROPOSED SWALE DRAIN
	OFFSET FROM BUILDING LINE
	PROPOSED SEWER, MAINT. STRUCTURES
	EXISTING SEWER, MAINT. STRUCTURES
	EXISTING WATER
	EXISTING GAS
	EXISTING ELECTRICITY
	EXISTING TELECOMMUNICATION
	EXISTING DRINKING WATER
	EXISTING NON-DRINKING WATER
	EXISTING WATER AND GAS CONDUIT
	VEHICLE CROSSING AND FOOTPATH
	LOT GRADING (CUT)
	LOT GRADING (FILL LESS THAN 300mm DEEP)

WARNING
HIGH PRESSURE GAS MAINS IN CLOSE PROXIMITY

WARNING

BEWARE OF UNDERGROUND SERVICES

THE LOCATION OF UNDERGROUND SERVICES ARE APPROXIMATE ONLY AND THEIR EXACT POSITION SHOULD BE PROVEN ON SITE. NO GUARANTEE IS GIVEN THAT ALL EXISTING SERVICES ARE SHOWN.

CONTRACTOR TO VERIFY EXISTING SERVICES
CONNECTION LEVELS PRIOR TO CONSTRUCTION.
ANY DISCREPANCIES MUST BE IMMEDIATELY
IDENTIFIED AND THE SUPERINTENDENT NOTIFIED
PRIOR TO CONSTRUCTION COMMENCING.

COUNCIL REFERENCE
WYP9651/16

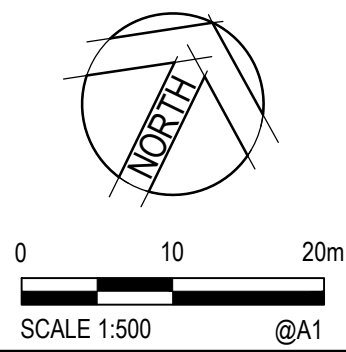
[illegible]

wes gault
wes@gault.net.au
0408 692 443

gault ♦

projects through partnership

© Cardno Limited All Rights Reserved.
This document is produced by Cardno Limited solely for the benefit of and use by the client in accordance with the terms of the retainer. Cardno Limited does not and shall not assume any responsibility or liability whatsoever to any third party arising out of any use or reliance by third party on the content of this document.



Cardno Victoria Pty Ltd | ABN 47 106 610 913
Level 4, 501 Swanston Street
Melbourne VIC 3000
Tel: 03 8415 7777 Fax: 03 8415 7788
Web: www.cardno.com.au

Drawn	Date
N. WHITE	16.12.2022
Checked	Date
N. GLASSON	11.04.2025
Designed	Date
B. ZHENG	14.12.2022
Verified	Date
N. GLASSON	11.04.2025
Approved	Date
N. GLASSON	11.04.2025

Client	PARKLANE GARDENS DEVELOPMENT PTY LTD	
Project	PARKLANE GARDENS - STAGE 6 504-530 BALLAN ROAD, WYNDHAM VALE WYNDHAM CITY COUNCIL	Status
Title	CIVIL SITEWORKS DETAIL PLAN	Drawing No. A.H. Drawing Name

Status	AS CONSTRUCTED
--------	----------------

Datum A.H.D.	Melway Ref 233 J12	Scale 1:500	Size A1
Drawing Number V210926-6-CI-1050			Revision C

SERVICES TABLE									
STREET NAME	ROAD RESERVE	BACK OF KERB OFFSET	SEWER MAIN	GAS MAIN	DRINKING WATER	NON DRINKING WATER	TELECOM	ELECTRICAL	ELECTRICAL POLES
SAANICH DRIVE	16.00	4.20 W, 4.20 E	1.00 W	2.10 E	3.05 E	2.55 E	1.85 W	2.30-2.90 W	1.00 FROM BOK
MADELEINE WAY	16.00	4.20 W, 4.20 E	1.00 E	1.80 W	2.80 W	2.30 W	1.85 E	2.30-2.90 E	1.00 FROM BOK
KELSEY ROAD	16.00	4.20 N, 4.20 S	1.00 N, 1.00 S	2.10 N	3.05 N	2.55 N	1.85 S	2.30-2.90 S	1.00 FROM BOK

SERVICES NOTES

1. FOR DETAILS OF ELECTRICITY SUPPLY RETICULATION AND TELECOMMUNICATION SERVICES LAYOUTS REFER TO AUTHORITY APPROVED DRAWINGS. FOR DETAILS OF SEWER AND WATER RETICULATIONS REFER TO CARDNO DRAWINGS.
2. ELECTRICITY CONDUITS AND PITS TO BE INSTALLED IN ACCORDANCE WITH ELECTRICAL RETICULATION DRAWINGS. LOCATIONS OF ALL CONDUITS SHALL BE MARKED ON THE KERB.
3. REFER TO TELECOMMUNICATION DRAWINGS FOR DETAILS OF CONDUIT LOCATIONS. TELECOMMUNICATION CONDUITS SHALL EXTEND 1.00m INTO ALLOTMENTS.
4. SERVICES SHALL DEViate AROUND DRAINAGE PITS AND SEWER MANHOLES WHERE NECESSARY.
5. CIVIL CONTRACTOR TO CONFIRM ELECTRICAL AND TELECOMMUNICATION TRENCH WIDTHS WITH SITE SUPERINTENDENT PRIOR TO CONSTRUCTION.
6. ELECTRICAL POLE OFFSET IS FROM BACK OF KERB TO TYPICAL CENTRE OF POLE. MIN 800mm CLEARANCE BETWEEN FACE OF POLE AND BACK OF KERB.
7. LOCATE TREES ALONG NATURE STRIP CENTRE LINE PROVIDING MIN 1000mm SETBACK FROM BACK OF KERB.

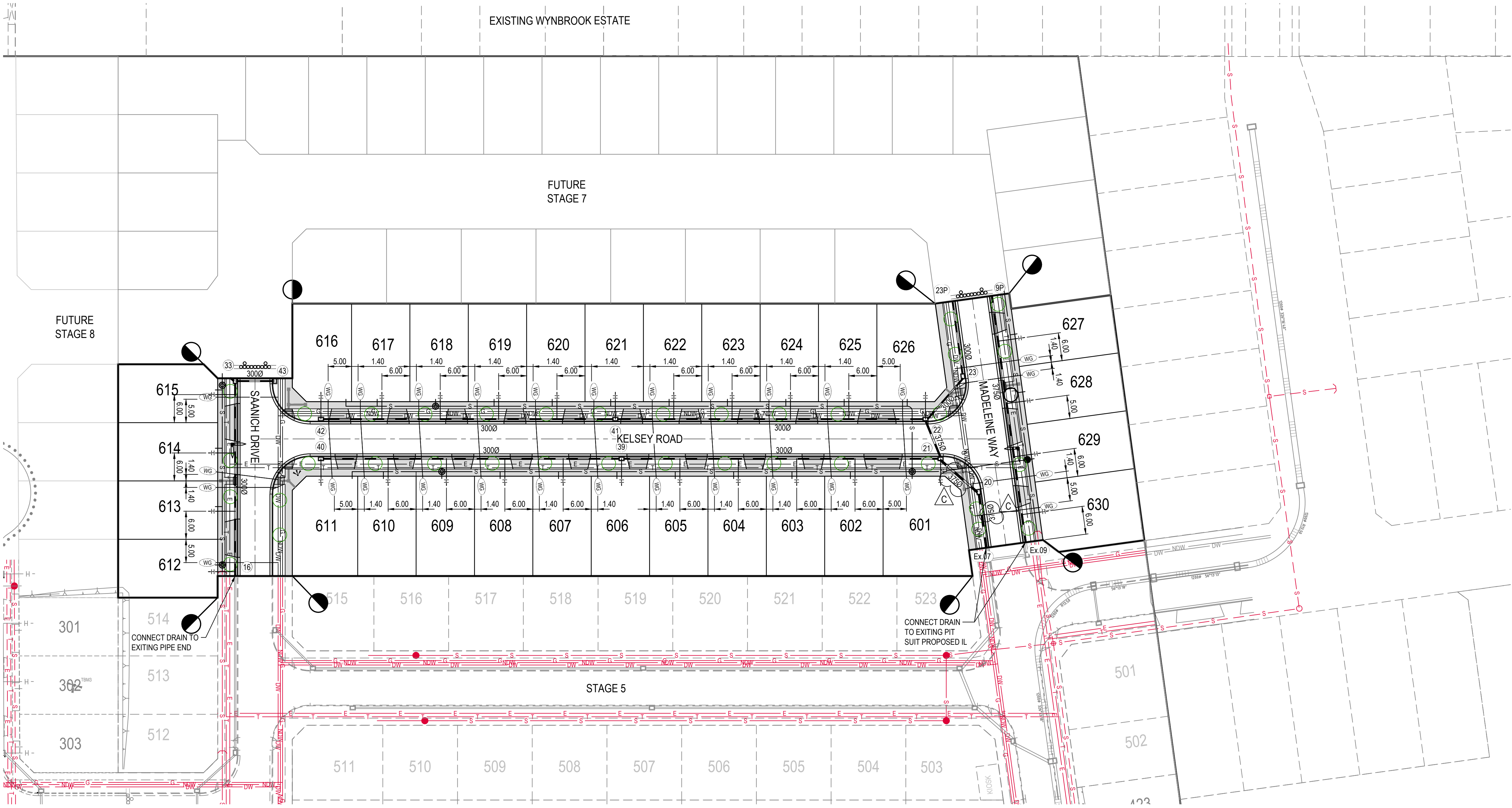

LEGEND	
	CENTRELINE OF ROAD
	KERB AND CHANNEL (AS SHOWN)
	PROPOSED RETAINING WALL
	PROPOSED ZERO LOT LINE
	STAGE BOUNDARY
	EXISTING TREE
	EXISTING TREE TO BE REMOVED
	EXISTING FEATURES TO BE REMOVED
	TACTILE GROUND SURFACE INDICATORS
	LIMIT OF WORKS
	"NO ROAD" SIGN AND BARRIER
	PROPOSED TRAFFIC SIGN
	PROPOSED STREET SIGN
	LINE MARKING AND RRPMS
	PROPOSED STORMWATER DRAIN, PIT, DIAMETER AND PROPERTY INLET
	PROPOSED MAIN DRAIN, PIT AND DIAMETER
	EXISTING STORMWATER DRAIN, PIT, DIAMETER AND PROPERTY INLET
	EXISTING DRAINAGE
	PROPOSED SWALE DRAIN
	OFFSET FROM BUILDING LINE
	PROPOSED SEWER, MAINTENANCE STRUCTURES AND PROPERTY BRANCH
	EXISTING SEWER, MAINT. STRUCTURES
	PROPOSED WATER
	PROPOSED GAS
	PROPOSED ELECTRICITY
	PROPOSED TELECOMMUNICATION
	PROPOSED RISING MAIN
	PROPOSED DRINKING WATER
	PROPOSED NON-DRINKING WATER
	CONDUIT
	WATER 100mmØ CLASS 12 UPVC
	GAS 50mmØ CLASS 12 UPVC
	EXISTING SHOWN OTHERWISE
	EXISTING WATER
	EXISTING GAS
	EXISTING ELECTRICITY
	EXISTING TELECOMMUNICATION
	EXISTING RISING MAIN
	EXISTING DRINKING WATER
	EXISTING NON-DRINKING WATER
	EXISTING WATER AND GAS CONDUIT
	1.5m RADIUS NO DIG ZONE AROUND EXISTING OVERHEAD ELECTRICAL POLES
	VEHICLE CROSSING AND FOOTPATH
	PROPOSED LIGHT POLE REFER TO POWERCORD DRAWING PC440 17433

WARNING
HIGH PRESSURE GAS MAINS IN CLOSE PROXIMITY

WARNING
BEWARE OF UNDERGROUND SERVICES
THE LOCATION OF UNDERGROUND SERVICES ARE APPROXIMATE ONLY AND THEIR EXACT POSITION SHOULD BE PROVEN ON SITE. NO GUARANTEE IS GIVEN THAT ALL EXISTING SERVICES ARE SHOWN.

CONTRACTOR TO VERIFY EXISTING SERVICES
CONNECTION LEVELS PRIOR TO CONSTRUCTION.
ANY DISCREPANCIES MUST BE IMMEDIATELY
IDENTIFIED AND THE SUPERINTENDENT NOTIFIED
PRIOR TO CONSTRUCTION COMMENCING.

ALL EXISTING FENCES, GATES AND STRUCTURES
WITHIN STAGE BOUNDARY ARE TO BE REMOVED
OFF SITE

WARNING
BEWARE OF OVERHEAD ELECTRICITY
ALL EXISTING OVERHEAD POWERLINES TO BE
RETAINED AND PROTECTED. CONTRACTOR TO
OBTAIN WRITTEN PERMISSION FROM POWERCOR
PRIOR TO COMMENCING ANY WORK IN "NO GO
ZONE" 3.0m EITHER SIDE OF OUTER POWER LINES.

COUNCIL REFERENCE
WYP9651/16

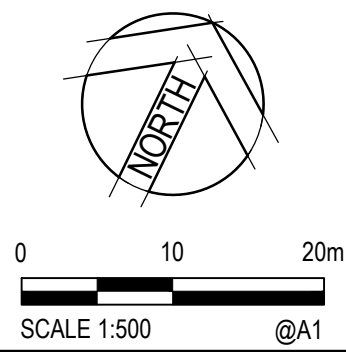
[illegible]

wes gault
wes@gault.net.au
0408 692 443

gault ♦

projects through partnership

© Cardno Limited All Rights Reserved.
This document is produced by Cardno Limited solely for the benefit of and use by the client in accordance with the terms of the retainer. Cardno Limited does not and shall not assume any responsibility or liability whatsoever to any third party arising out of any use or reliance by third party on the content of this document.



Cardno Victoria Pty Ltd | ABN 47 106 610 913
Level 4, 501 Swanston Street
Melbourne VIC 3000
Tel: 03 8415 7777 Fax: 03 8415 7788
Web: www.cardno.com.au

Drawn	Date
N. WHITE	16.12.2022
Checked	Date
N. GLASSON	11.04.2025
Designed	Date
B. ZHENG	14.12.2022
Verified	Date
N. GLASSON	11.04.2025
Approved	Date
N. GLASSON	11.04.2025

Client	PARKLANE GARDENS DEVELOPMENT PTY LTD	
Project	PARKLANE GARDENS - STAGE 6 504-530 BALLAN ROAD, WYNDHAM VALE WYNDHAM CITY COUNCIL	Status
Title	CIVIL SITEWORKS SERVICES PLAN	Datum A.H. Drawing n

Status	AS CONSTRUCTED
--------	----------------

Datum A.H.D.	Melway Ref 233 J12	Scale 1:500	Size A1
Drawing Number V210926-6-CI-1100			Revision C

DATE PLOTTED: 11 April 2025 10:05 AM BY: JENSEN, LAURA

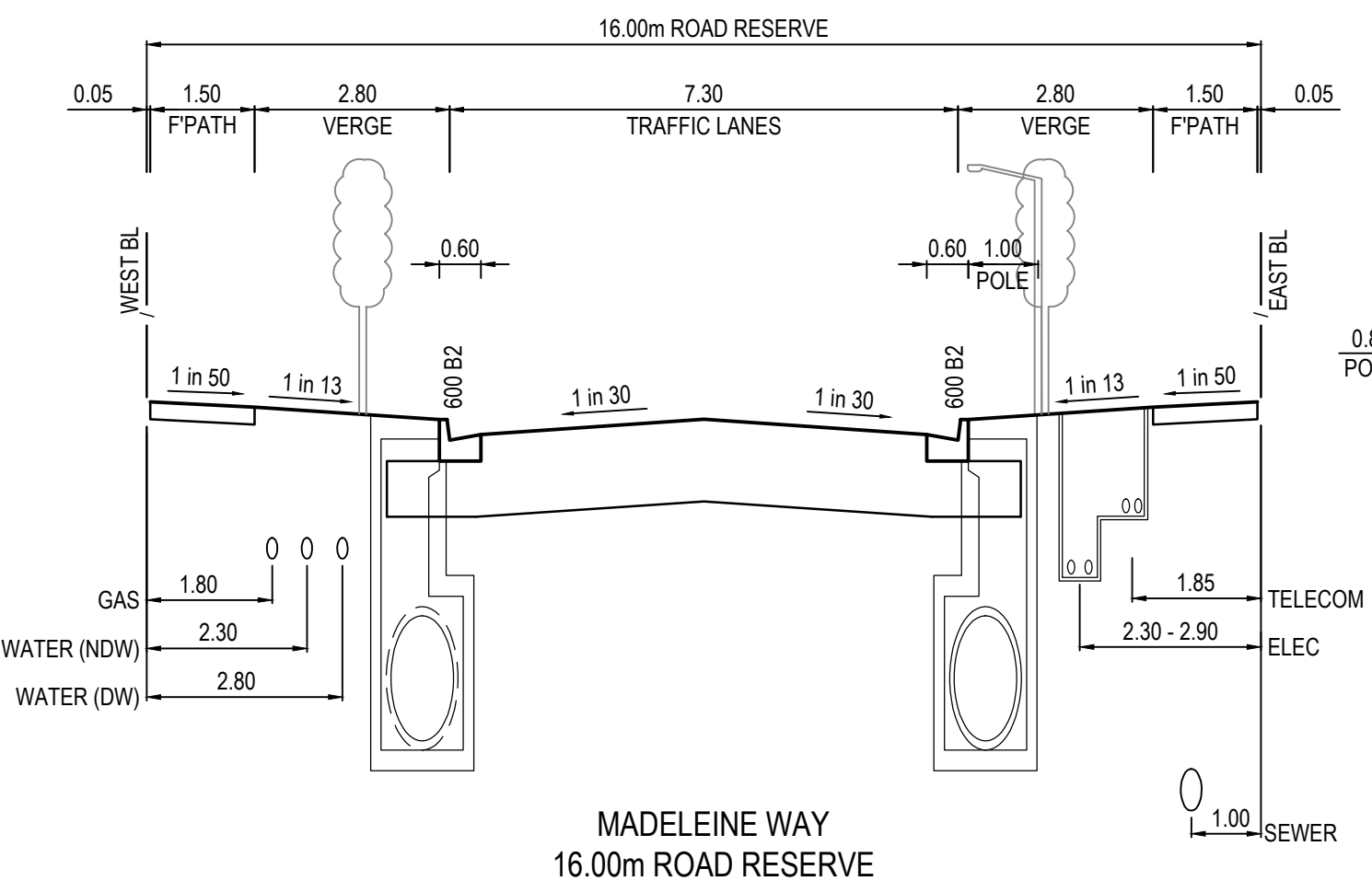
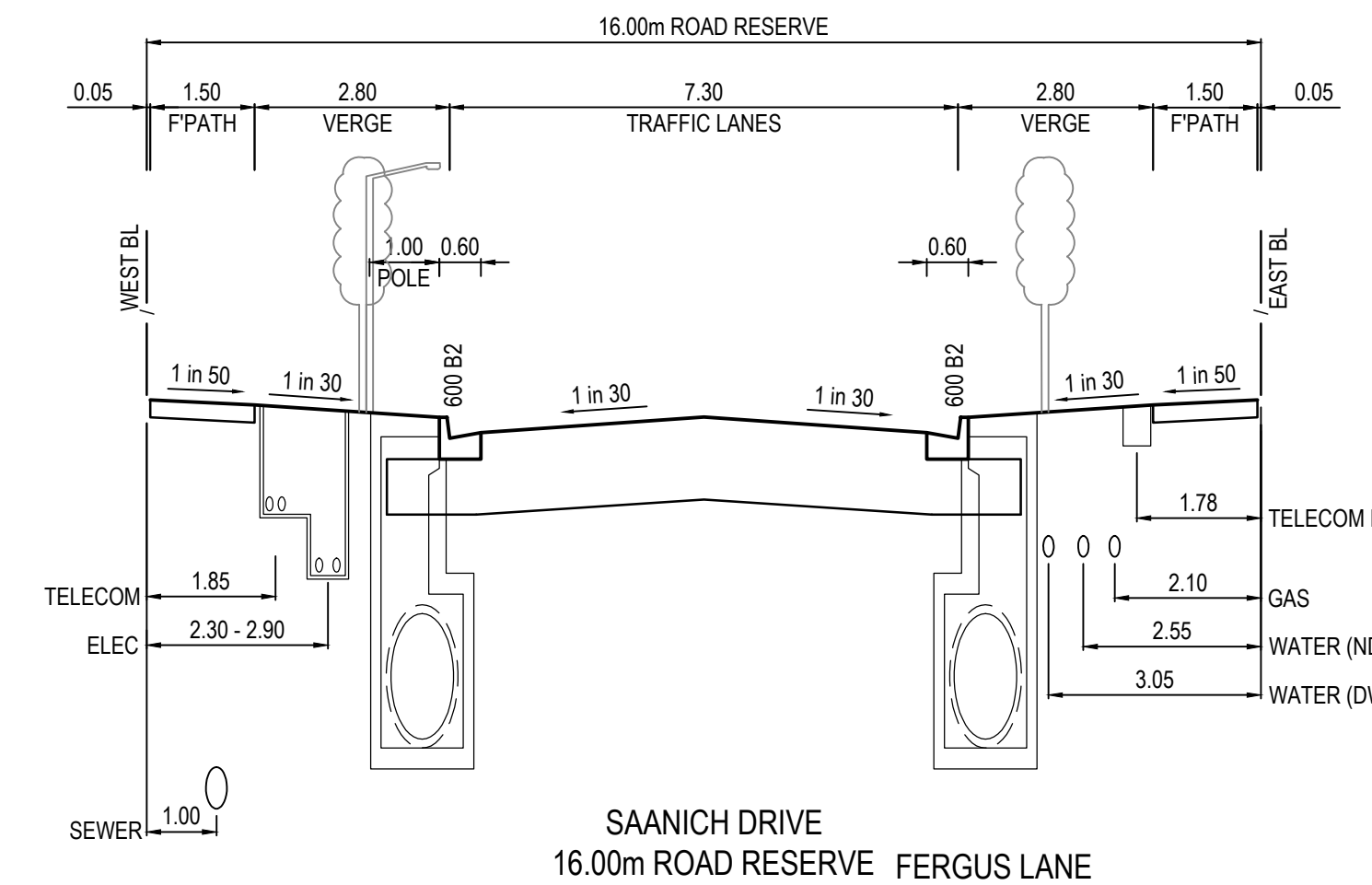
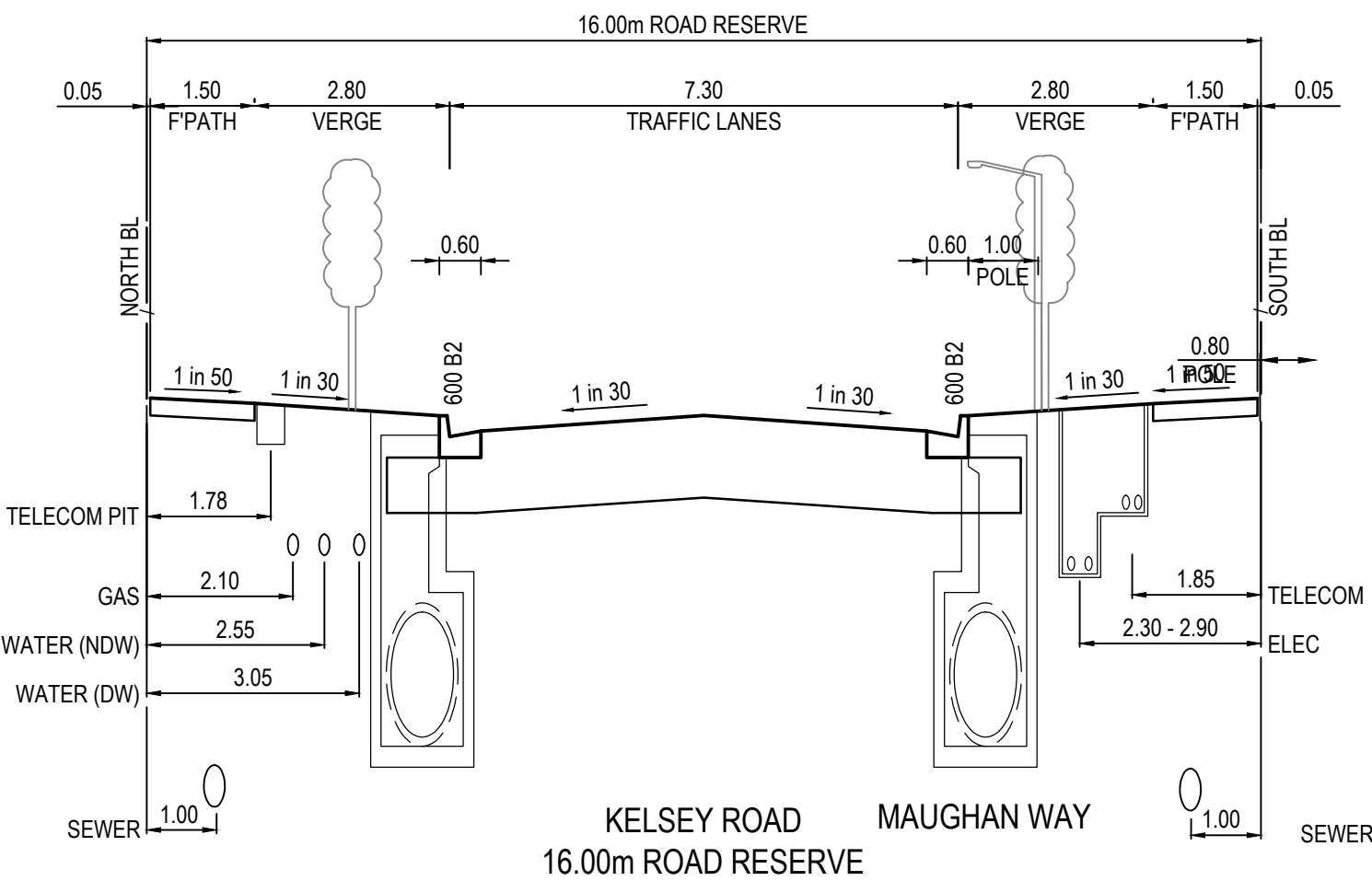

TYPICAL ROAD CROSS SECTIONS

NOT TO SCALE

NOTE: STREET TREES CENTRALLY LOCATED BETWEEN BACK OF KERB AND EDGE OF FOOTPATH UNLESS SHOWN OTHERWISE

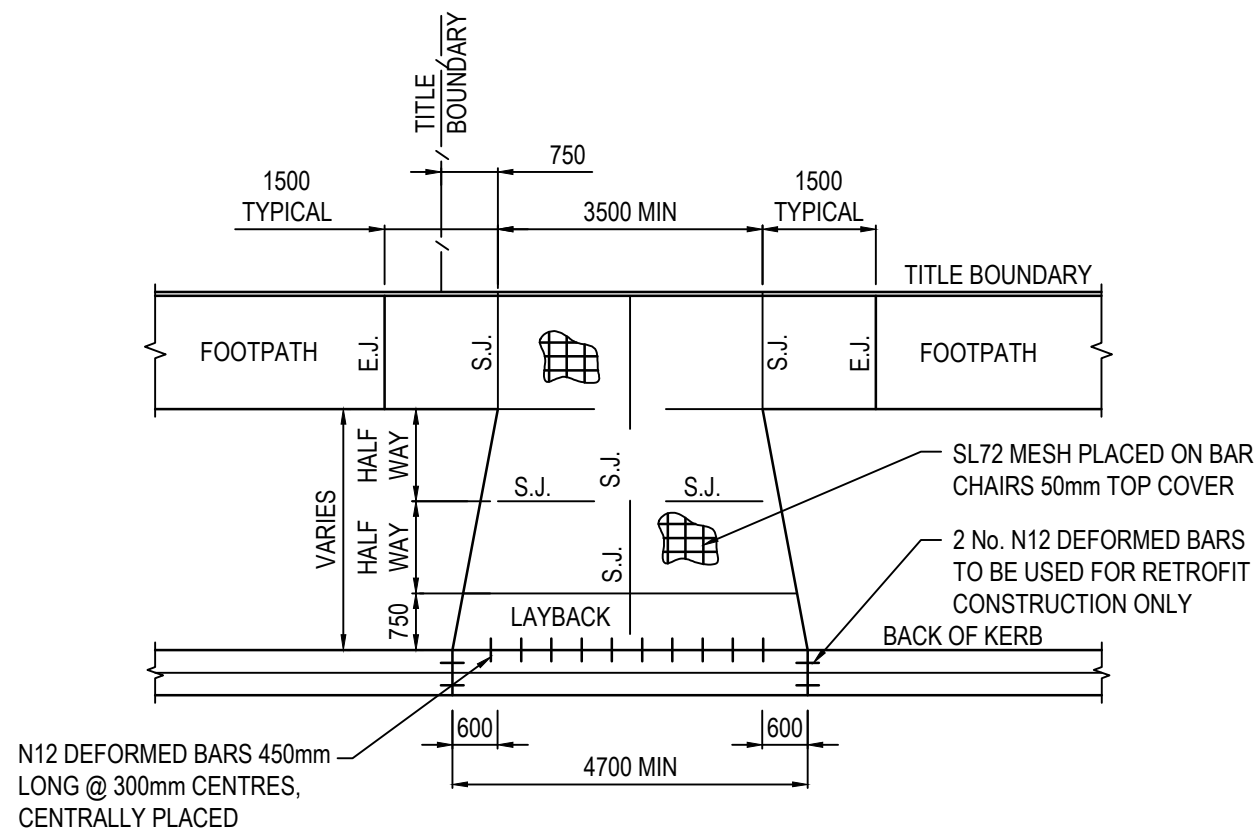

SINGLE RESIDENTIAL VEHICLE CROSSING

NOT TO SCALE

REFER WYNDHAM CITY COUNCIL STANDARD DRAWING No. SD4-1

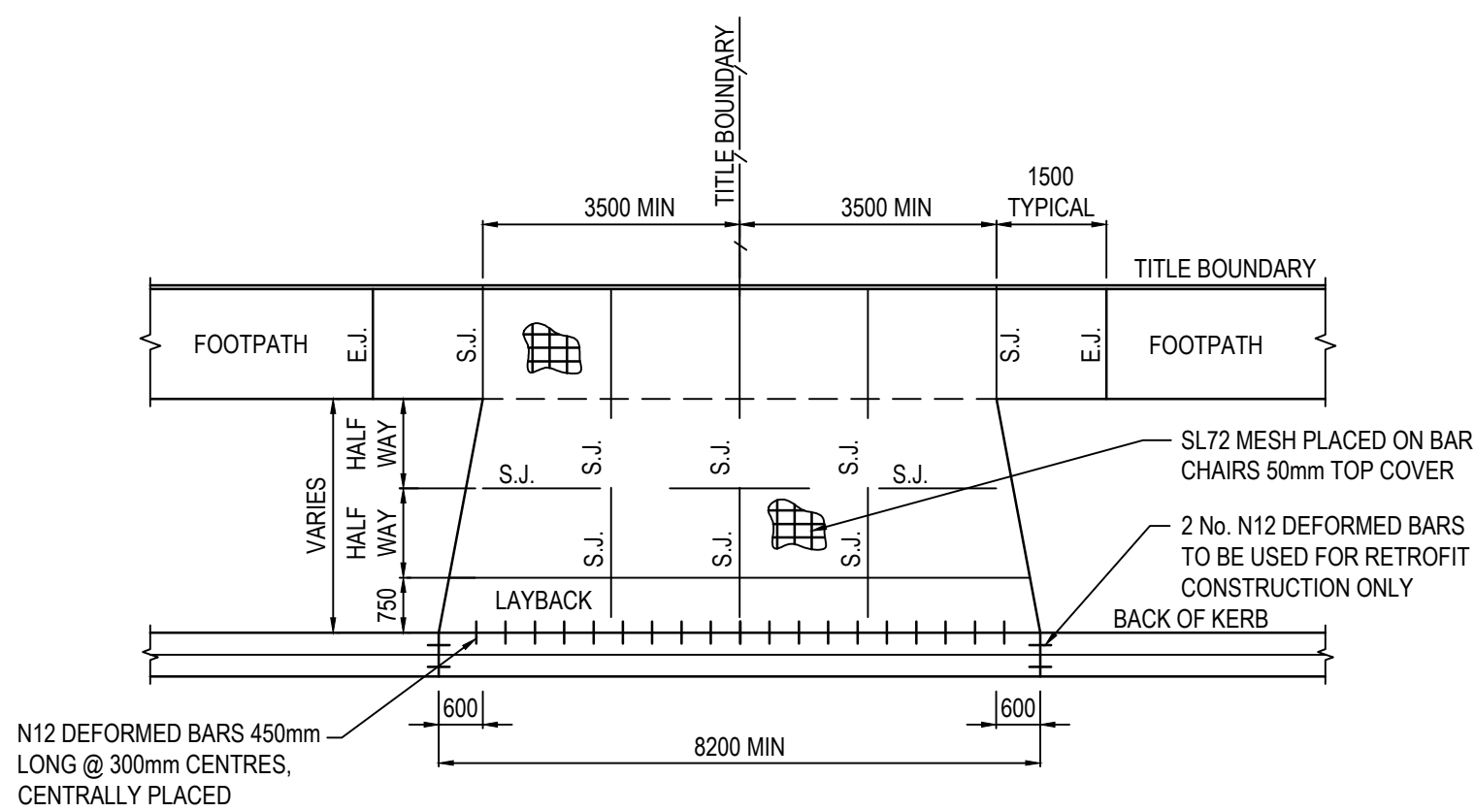

DOUBLE RESIDENTIAL VEHICLE CROSSING

NOT TO SCALE

REFER WYNDHAM CITY COUNCIL STANDARD DRAWING No. SD4-3

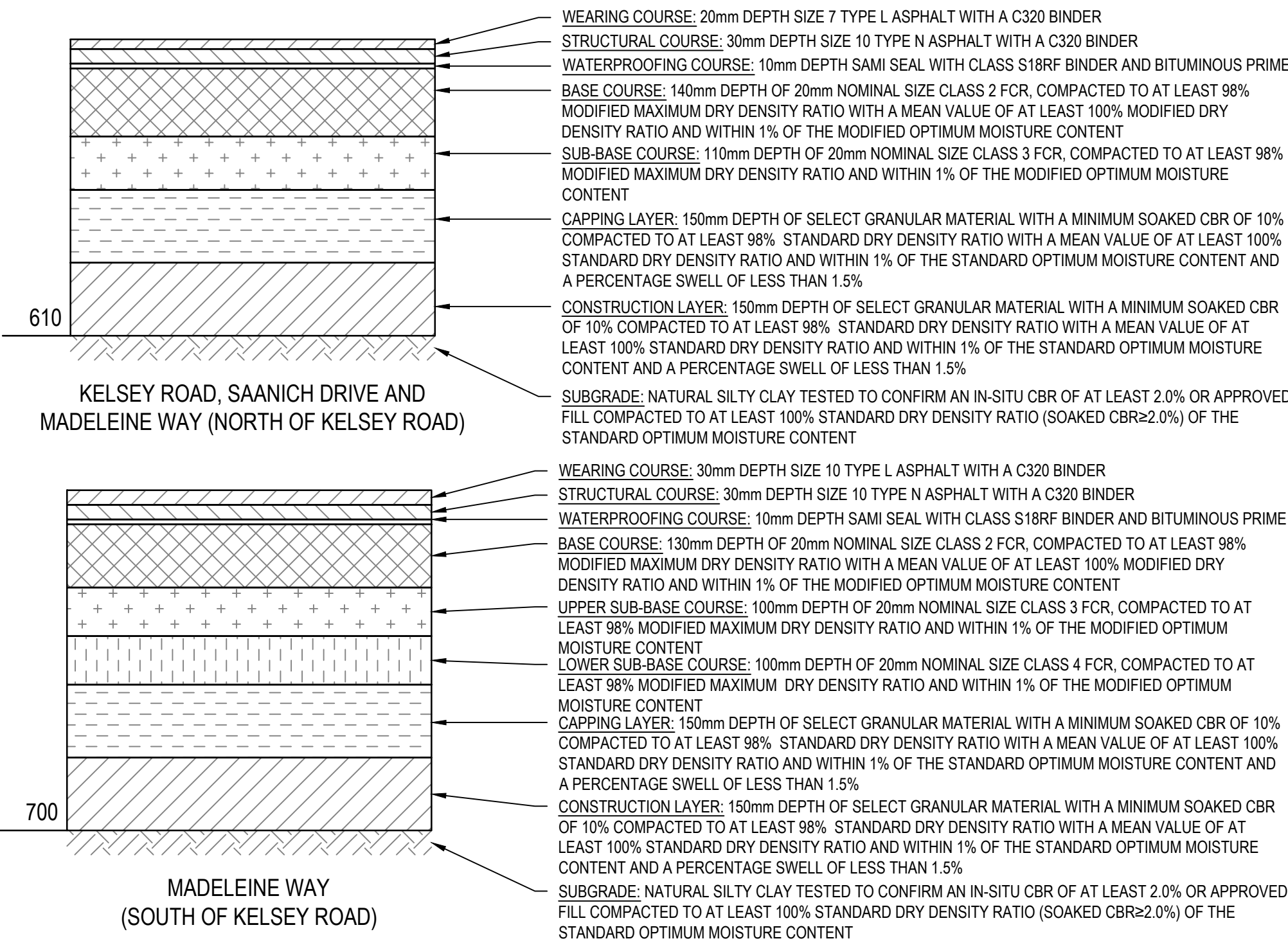

FLEXIBLE PAVEMENT COMPOSITIONS

NOT TO SCALE

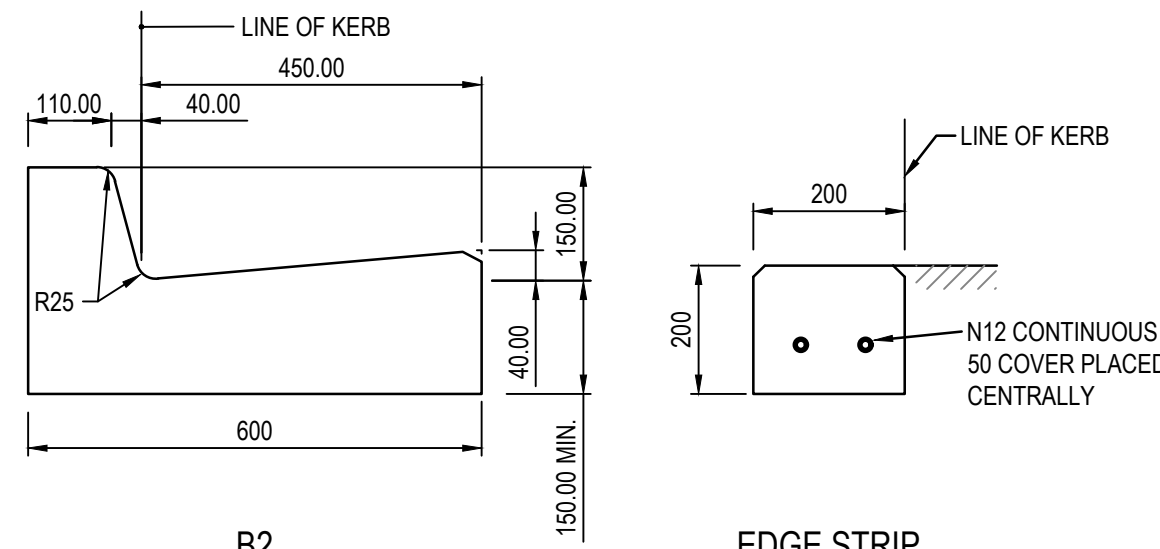

KERB TYPES

NOT TO SCALE

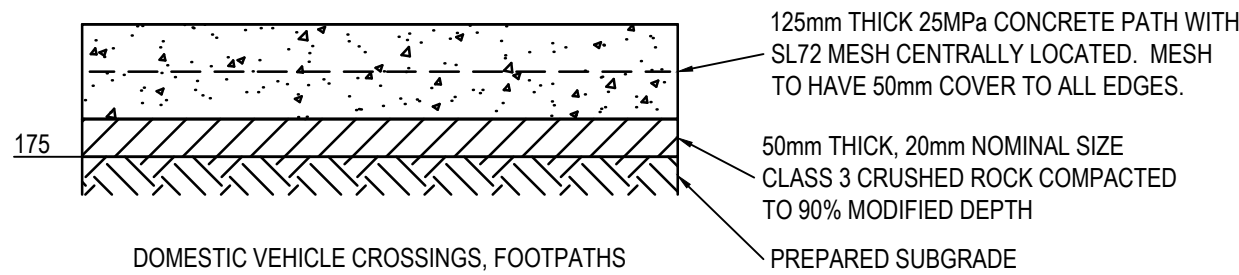

RIGID PAVEMENT COMPOSITIONS

NOT TO SCALE

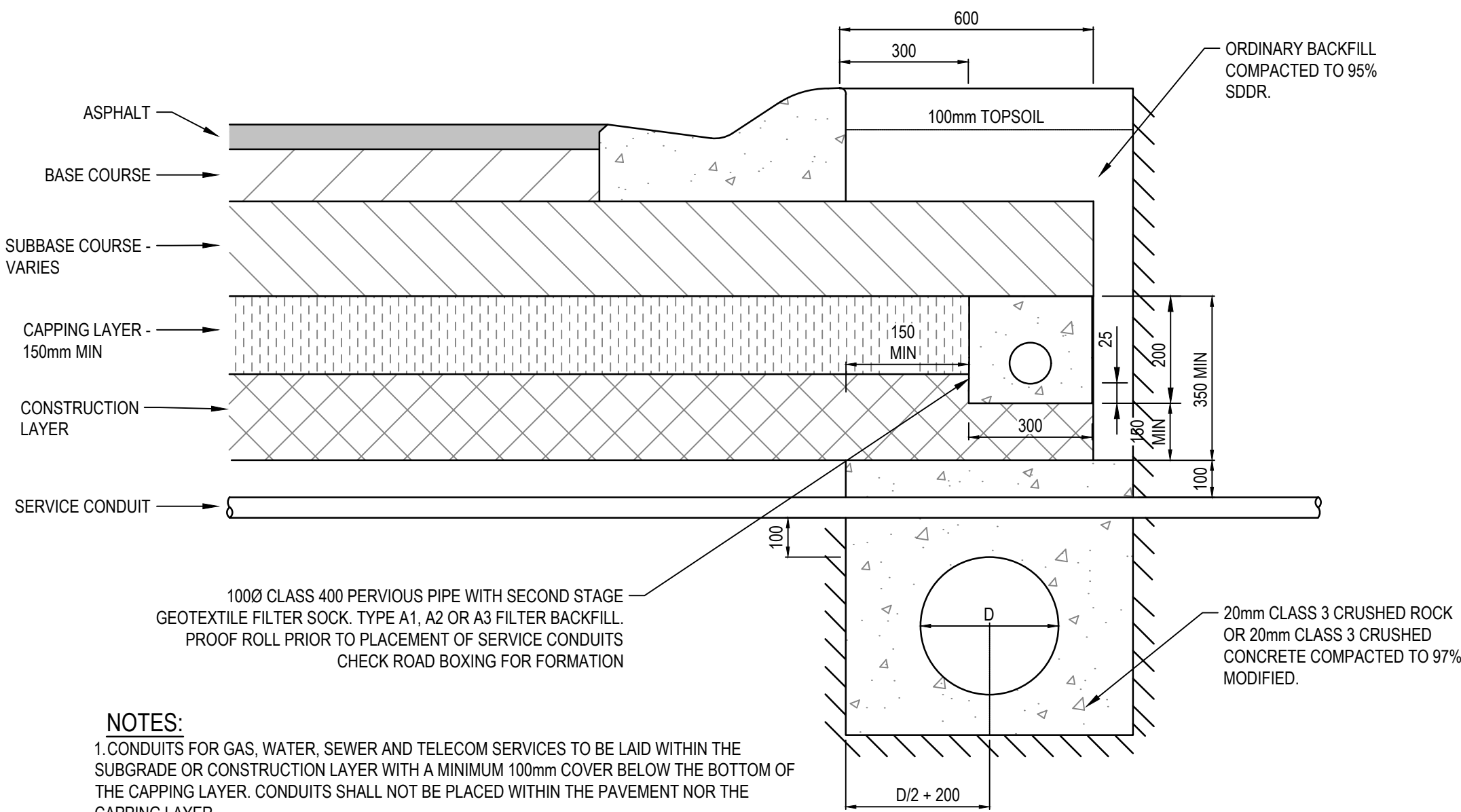

NOTES:

1. CONDUITS FOR GAS, WATER, SEWER AND TELECOM SERVICES TO BE LAID WITHIN THE SUBGRADE OR CONSTRUCTION LAYER WITH A MINIMUM 100mm COVER BELOW THE BOTTOM OF THE CAPPING LAYER. CONDUITS SHALL NOT BE PLACED WITHIN THE PAVEMENT NOR THE CAPPING LAYER.
2. SERVICE CONDUITS TO BE INSTALLED AFTER PLACEMENT OF THE CONSTRUCTION LAYER AT A GRADE OF 1 IN 100 FALLING TO THE SIDE OF THE PROPOSED UTILITY MAIN
3. SERVICE TRENCH BACKFILL TO BE 20mm CLASS 3 CR, RECYCLED CONCRETE OR COUNCIL APPROVED EQUIVALENT
4. FOR ELECTRICAL SERVICES, WHERE THE CONDUIT IS GREATER THAN 200mm BELOW THE CAPPING LAYER, THE MARKER TAPE MUST BE PLACED 150mm ABOVE THE CONDUIT OR PER THE ELECTRICAL AUTHORITY'S REQUIREMENTS
5. CONSTRUCTION LAYERS AND CAPPING LAYER MATERIAL MUST HAVE THE FOLLOWING SPECIFICATIONS:
 - MIN. CBR=8%, - MAX. SWELL=1.5%, - MAX. PERMEABILITY=5x10⁻⁹ m/s
6. ALL DIMENSIONS IN MILLIMETRES WHERE NOT SPECIFIED.

SUBSURFACE DRAIN IN EXPANSIVE SOILS

NOT TO SCALE

(REFER VPA STD DWG EDMC 202)

Rev.	Date	Description	Des.	Verif.	Appd.
B	11.04.2025	AS CONSTRUCTED	B.C.	N.G.	N.G.
A	20.04.2023	ISSUED FOR CONSTRUCTION	B.C.	N.G.	N.G.



© Cardno Limited All Rights Reserved.
This document is produced by Cardno Limited solely for the benefit of and use by the client in accordance with the terms of the retainer. Cardno Limited does not and shall not assume any responsibility or liability whatsoever to any third party arising out of any use or reliance by third party on the content of this document.



Cardno Victoria Pty Ltd | ABN 47 106 610 913
Level 4, 501 Swarston Street
Melbourne VIC 3000
Tel: 03 8415 7777 Fax: 03 8415 7788
Web: www.cardno.com.au

Drawn N. WHITE	Date 16.12.2022
Checked N. GLASSON	Date 11.04.2025
Designed B. ZHENG	Date 14.12.2022
Verified N. GLASSON	Date 11.04.2025
Approved	Date

Client PARKLANE GARDENS DEVELOPMENT PTY LTD	Project PARKLANE GARDENS - STAGE 6 504-530 BALLAN ROAD, WYNDHAM VALE WYNDHAM CITY COUNCIL
Drawing Number V210926-6-CI-1150	Revision B

AS CONSTRUCTED

Datum	Melway Ref	Scale	Size
A.H.D.	233 J12	AS SHOWN	A1

Revision

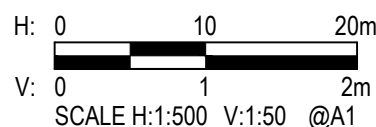

© Cardno Limited All Rights Reserved.
This document is produced by Cardno Limited solely for the benefit of and use by the client in accordance with the terms of the retainer. Cardno Limited does not and shall not assume any responsibility or liability whatsoever to any third party arising out of any use or reliance by third party on the content of this document.



Client	PARKLANE GARDENS DEVELOPMENT PTY LTD	
Project	PARKLANE GARDENS - STAGE 6 504-530 BALLAN ROAD, WYNDHAM VALE WYNDHAM CITY COUNCIL	Status
Title	CIVIL SITEWORKS KELSEY ROAD LONGITUDINAL SECTION	A.H Drawing n

Status			
AS CONSTRUCTED			
Date	Material Ref	Scale	Size
A.H.D.	233 J12	H1:500; V1:50	A1
Drawing Number			Revision
V210926-6-CI-1200			B

COUNCIL REFERENCE
WYP9651/16

DATE PLOTTED: 11 April 2025 10:05 AM BY: JENSEN, LAURA

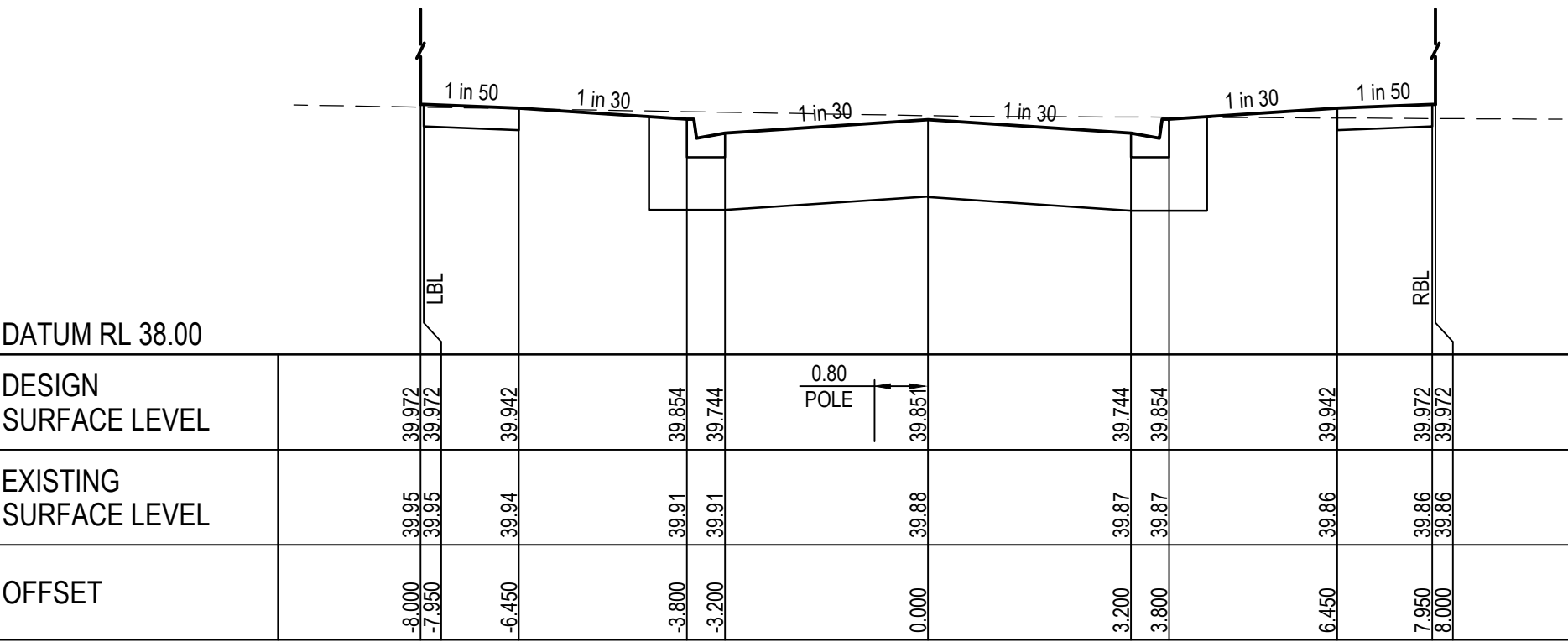

CH 84.5

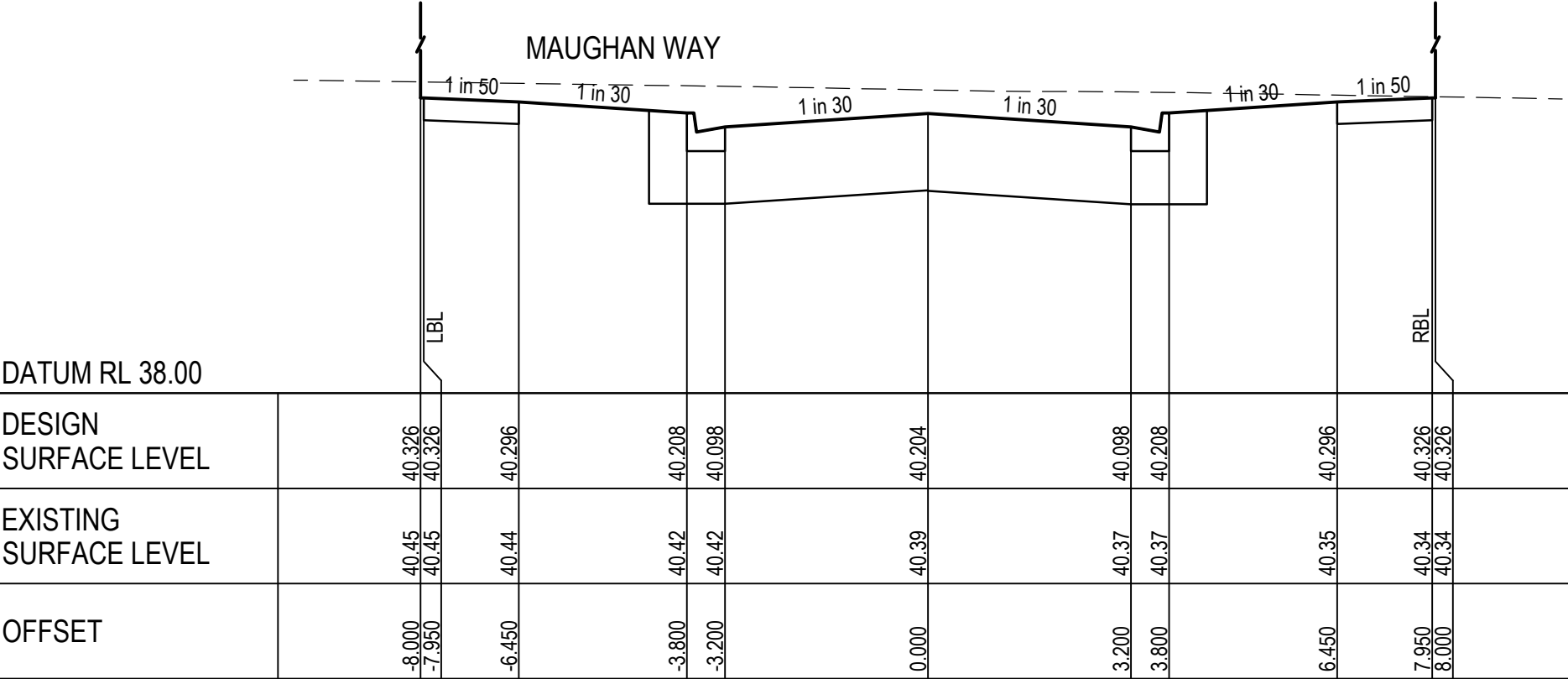

CH 59.5

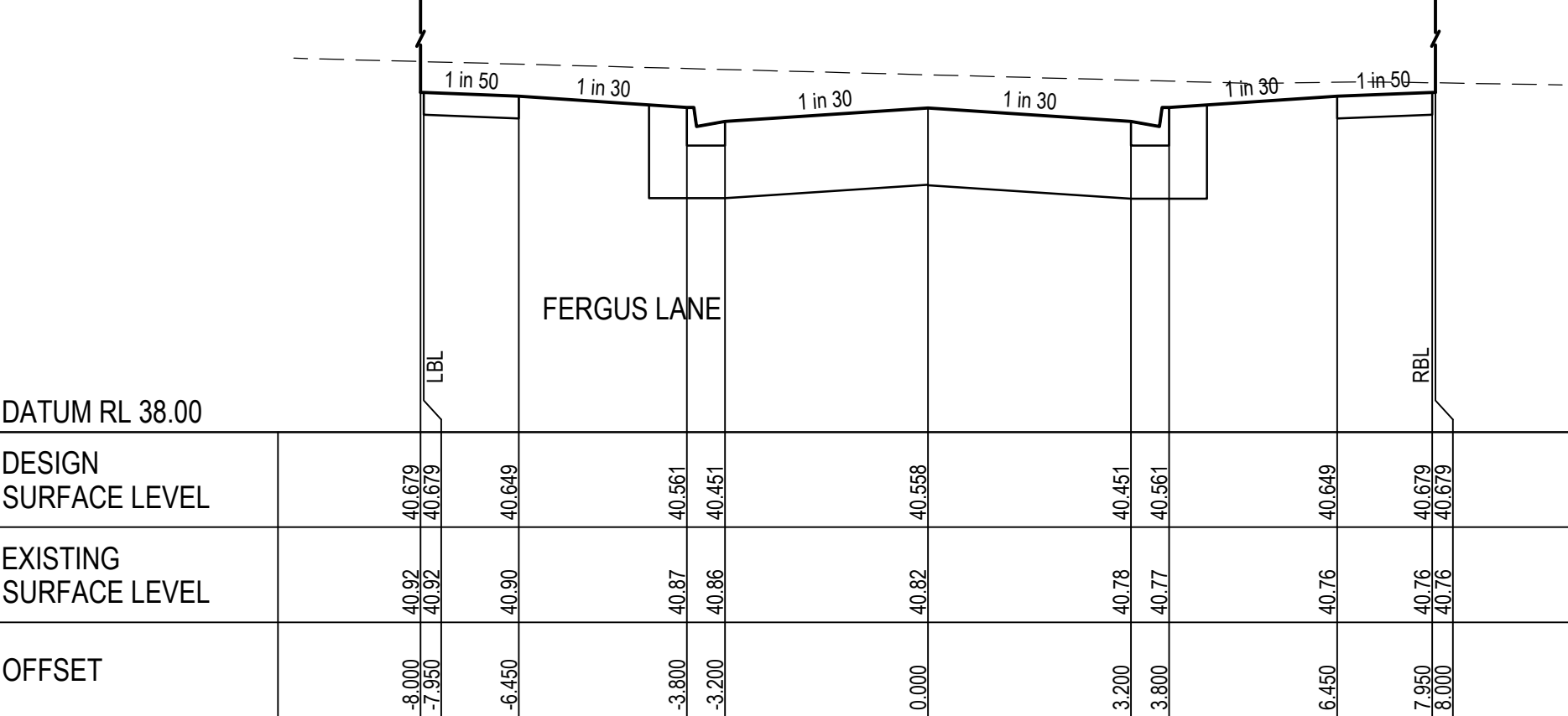

CH 34.5

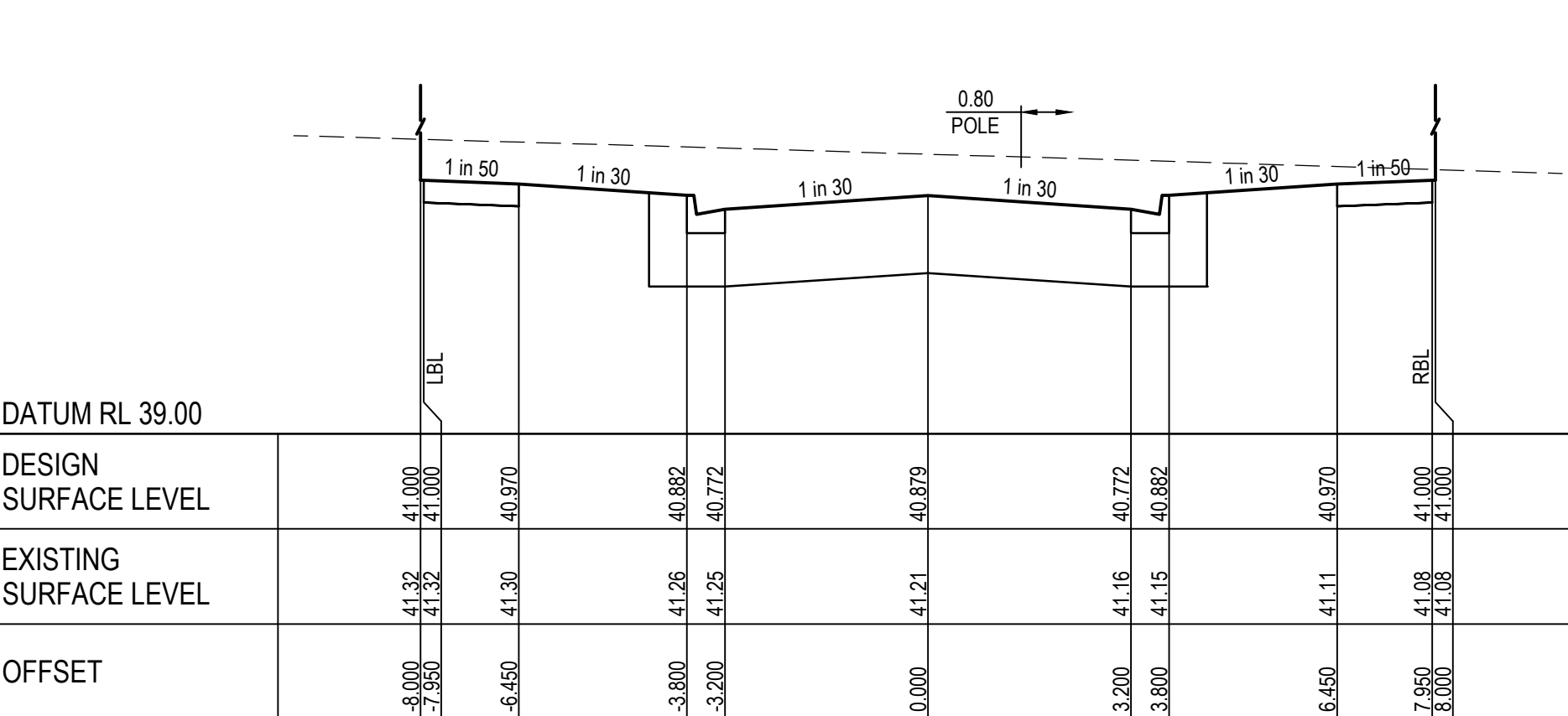

CH 11.8

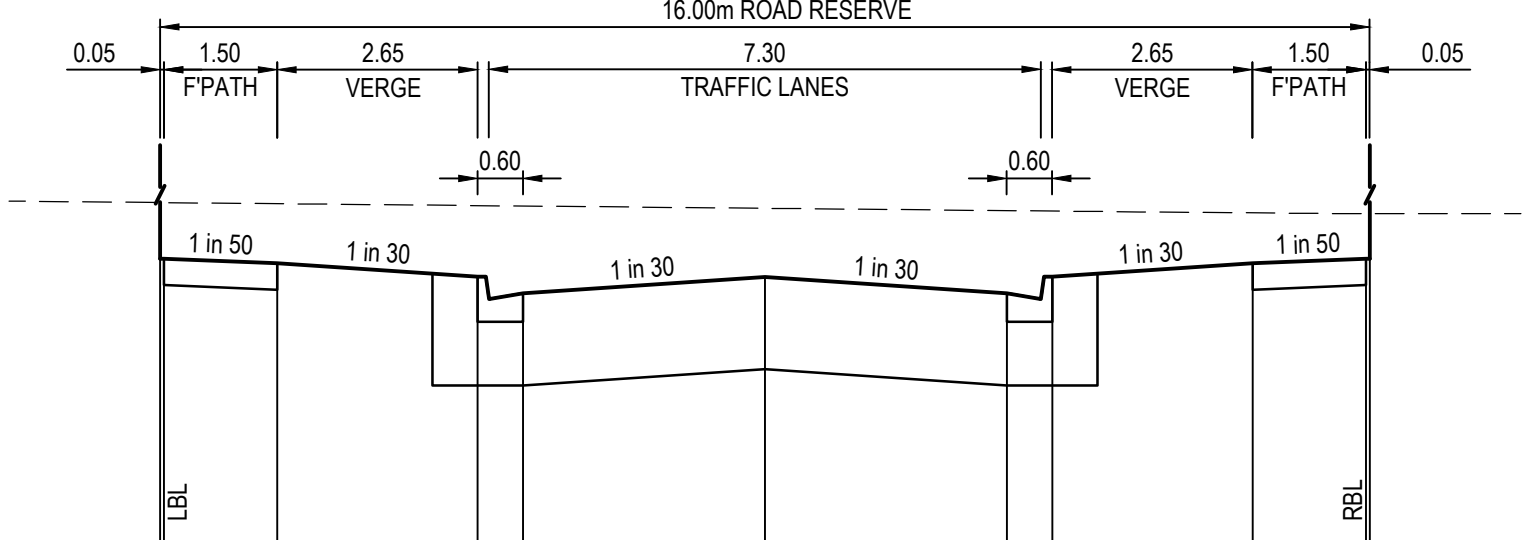

CH 144.185

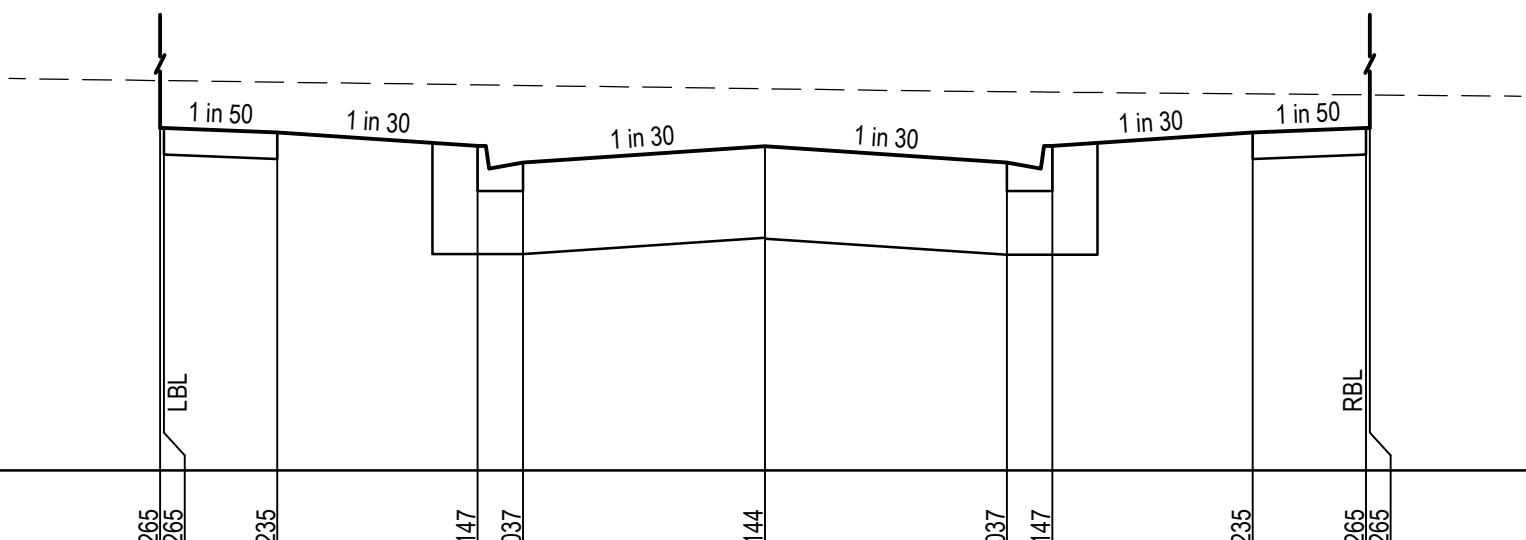

CH 134.5

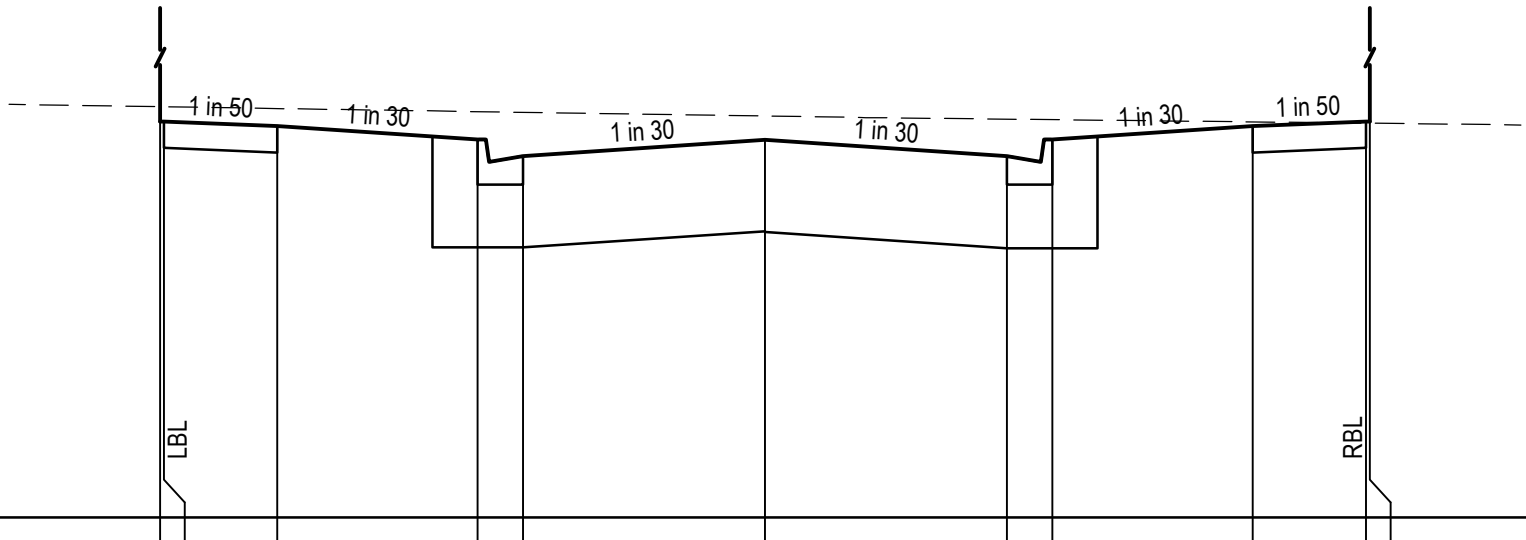

CH 109.5

LEGEND

- EXISTING SURFACE
- DESIGN SURFACE
- ROAD BOXING
- BUILDING LINE
- LBL LEFT BUILDING LINE
- RBL RIGHT BUILDING LINE

STRUCTURAL FILL REQUIRED UNDER PAVEMENT AND FOOTPATHS WHERE CONSTRUCTED ABOVE STRIPPED SURFACE

XREFs: XR-V210926-6-CI-Keasey
CAD File: U:\304\402023\Civil\Drawings\210926-6-CI-1201-1201.dwg

Rev.	Date	Description	Des.	Verif.	Appd.
B	11.04.2025	AS CONSTRUCTED	B.C.	N.G.	N.G.
A	20.04.2023	ISSUED FOR CONSTRUCTION	B.C.	N.G.	N.G.

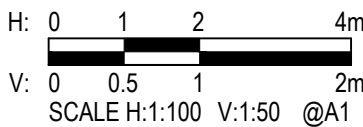

© Cardno Limited All Rights Reserved.
This document is produced by Cardno Limited solely for the benefit of and use by the client in accordance with the terms of the retainer. Cardno Limited does not and shall not assume any responsibility or liability whatsoever to any third party arising out of any use or reliance by third party on the content of this document.



Cardno Victoria Pty Ltd | ABN 47 106 610 913
Level 4, 501 Swanston Street
Melbourne VIC 3000
Tel: 03 8415 7777 Fax: 03 8415 7788
Web: www.cardno.com.au

Drawn	N. WHITE	Date	16.12.2022
Checked	N. GLASSON	Date	11.04.2025
Designed	B. ZHENG	Date	14.12.2022
Verified	N. GLASSON	Date	11.04.2025
Approved		Date	

Client	PARKLANE GARDENS DEVELOPMENT PTY LTD
Project	PARKLANE GARDENS - STAGE 6 504-530 BALLAN ROAD, WYNDHAM VALE WYNDHAM CITY COUNCIL
Title	CIVIL SITEWORKS KELSEY ROAD CROSS SECTIONS

Status	AS CONSTRUCTED
Datum	A.H.D.
Melway Ref	233 J12
Scale	H1:100; V1:50
Size	A1
Drawing Number	V210926-6-CI-1201
Revision	B

COUNCIL REFERENCE
WYP9651/16



Rev.	Date	Description	Des.	Verif.	Appd.
B	11.04.2025	AS CONSTRUCTED	B.C.	N.G.	N.G.
A	20.04.2023	ISSUED FOR CONSTRUCTION	B.C.	N.G.	N.G.

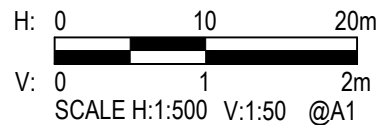

© Cardno Limited All Rights Reserved.
This document is produced by Cardno Limited solely for the benefit of and use by the client in accordance with the terms of the retainer. Cardno Limited does not and shall not assume any responsibility or liability whatsoever to any third party arising out of any use or reliance by third party on the content of this document.





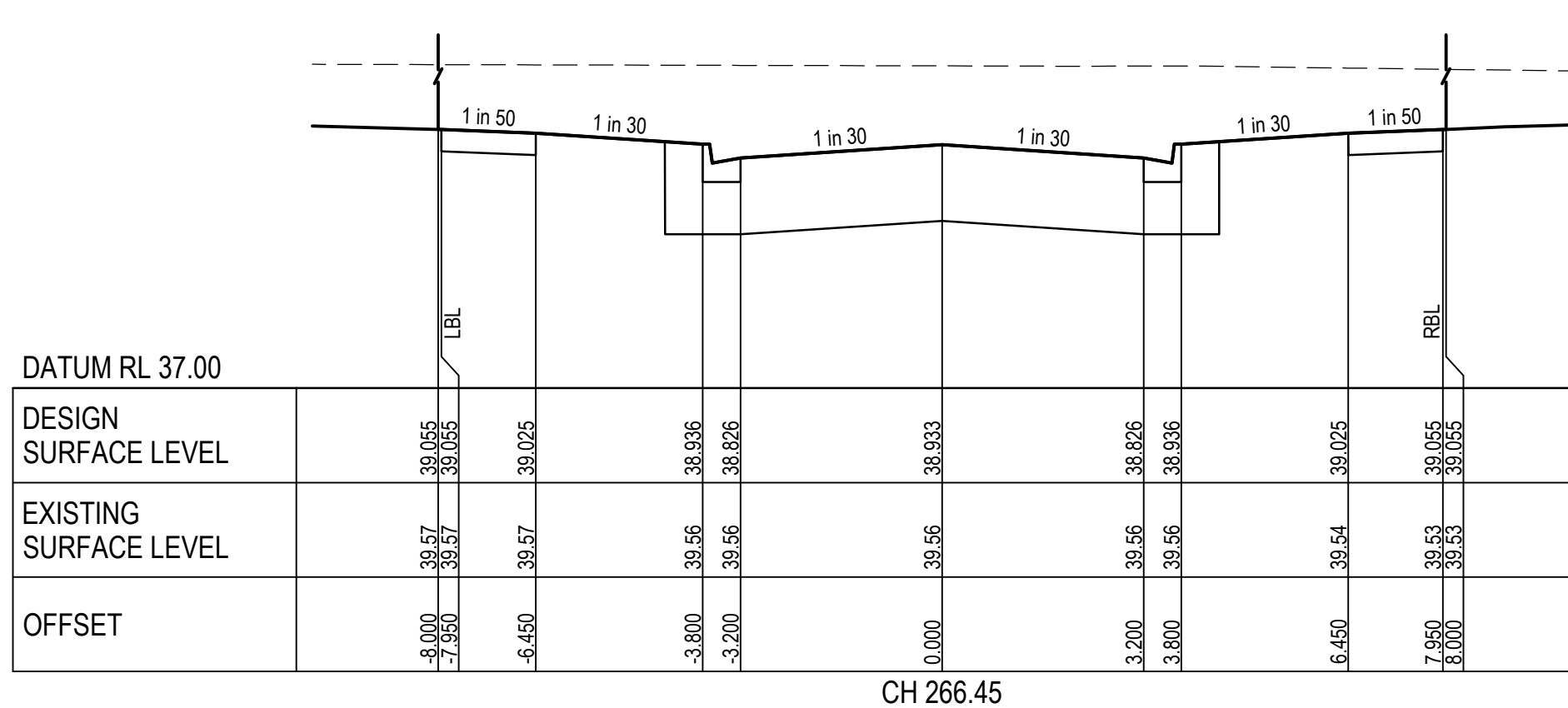
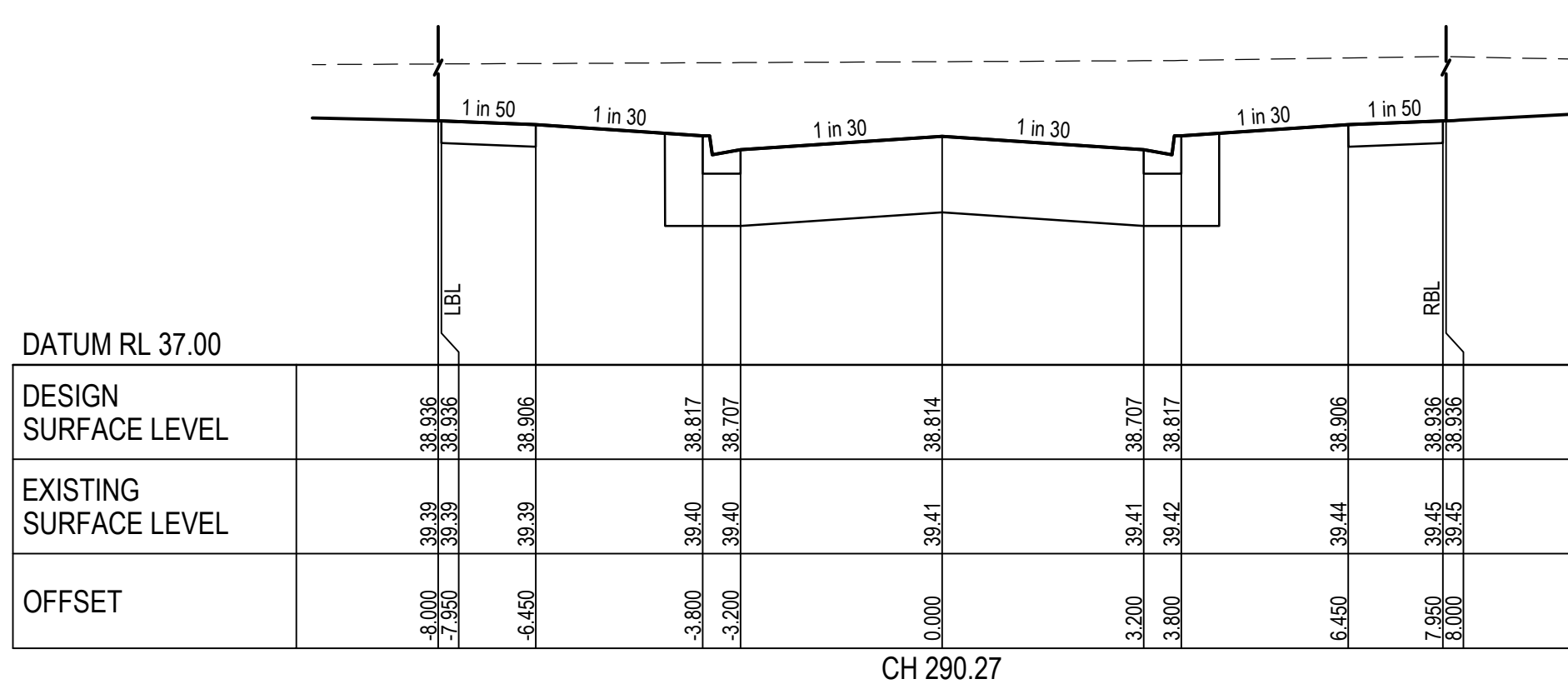
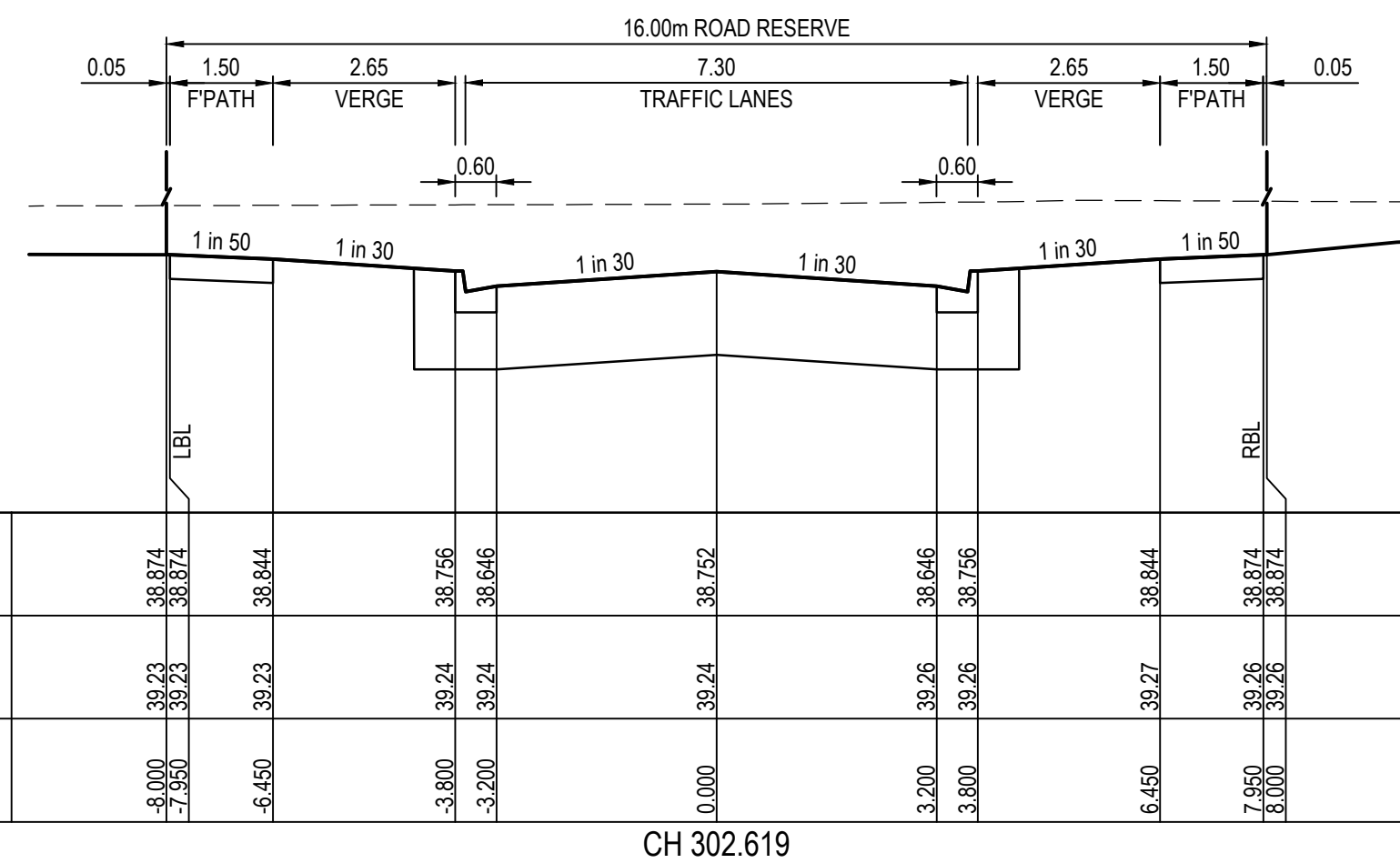
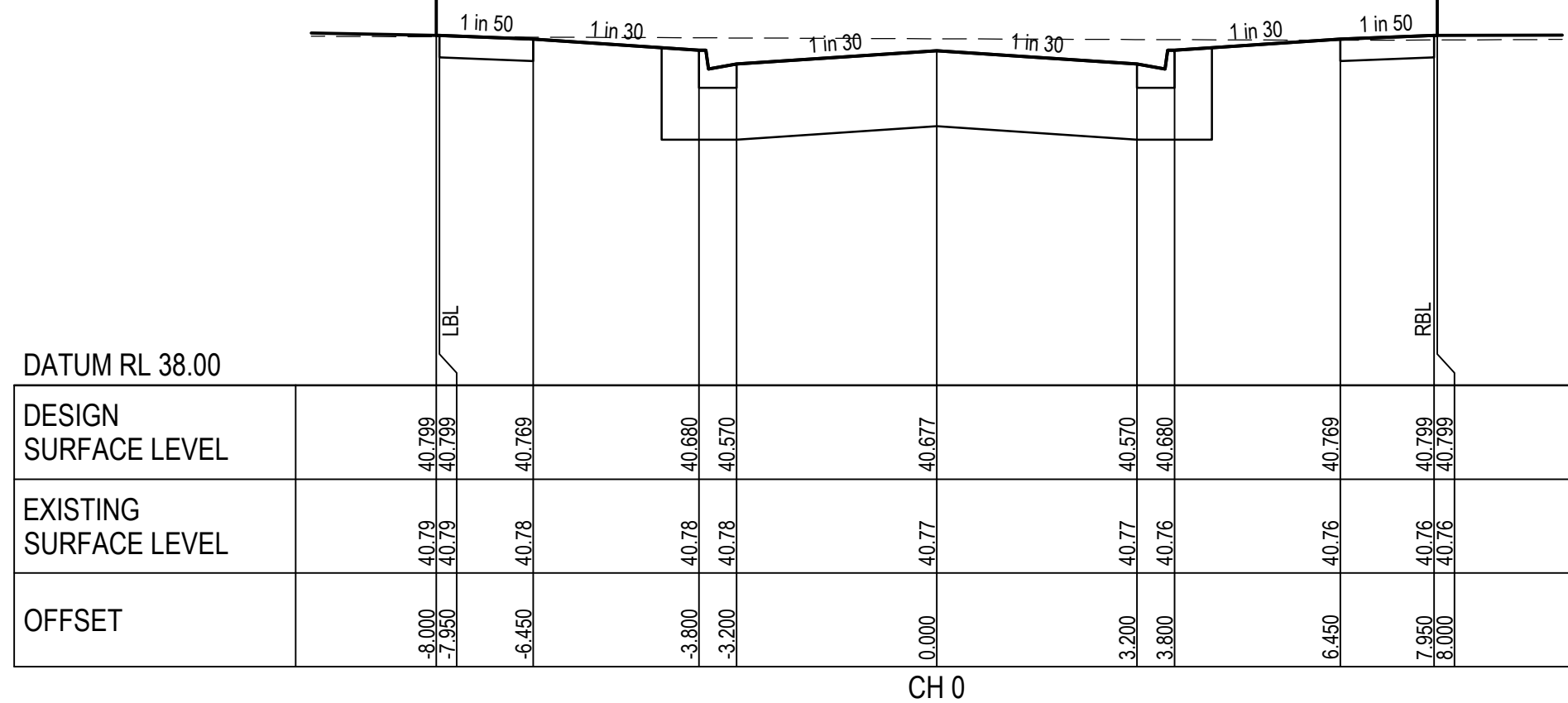
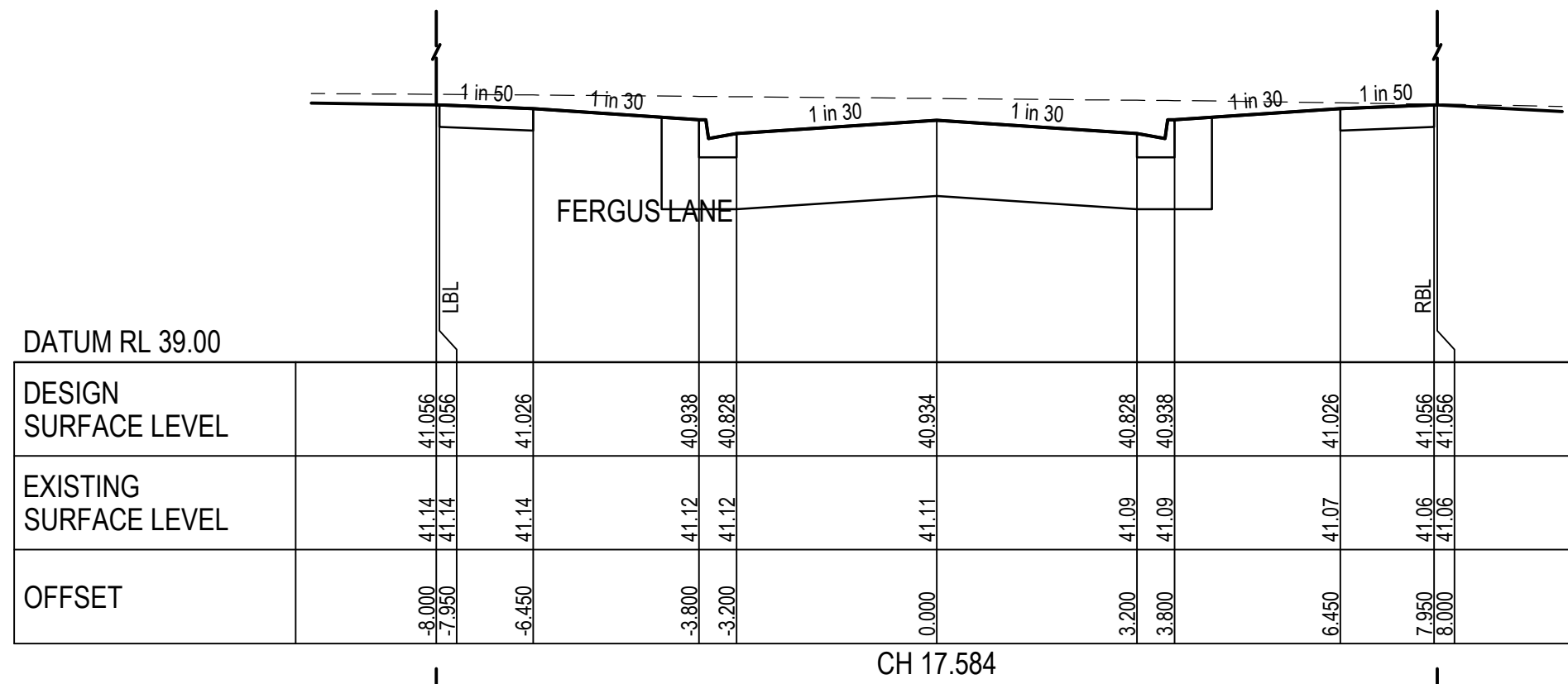
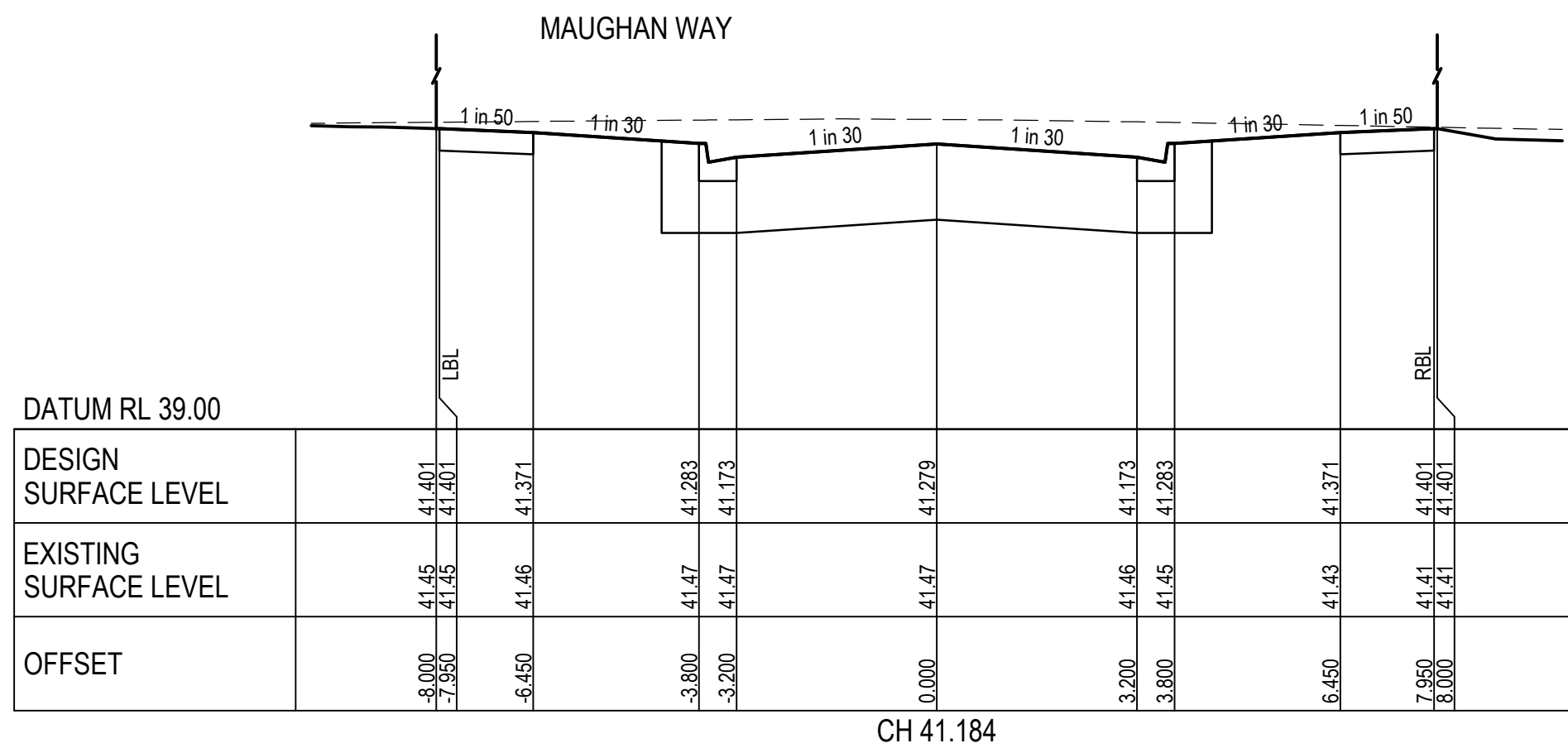

Cardno Victoria Pty Ltd | ABN 47 106 610 913
Level 4, 501 Swanston Street
Melbourne VIC 3000
Tel: 03 8415 7777 Fax: 03 8415 7788
Web: www.cardno.com.au

Drawn N. WHITE	Date 16.12.2022
Checked N. GLASSON	Date 11.04.2025
Designed B. ZHENG	Date 14.12.2022
Verified N. GLASSON	Date 11.04.2025
Approved	Date
N. GLASSON	11.04.2025

Client PARKLANE GARDENS DEVELOPMENT PTY LTD	Project PARKLANE GARDENS - STAGE 6 504-530 BALLAN ROAD, WYNDHAM VALE WYNDHAM CITY COUNCIL	Status AS CONSTRUCTED
Title CIVIL SITEWORKS MADELEINE WAY - SAANICH DRIVE LONGITUDINAL SECTION	Datum A.H.D.	Melway Ref 233 J12
	Scale H1:500; V1:50	Size A1
	Drawing Number V210926-6-CI-1250	Revision B



LEGEND	
	EXISTING SURFACE
	DESIGN SURFACE
	ROAD BOXING
	BUILDING LINE
LBL	LEFT BUILDING LINE
RBL	RIGHT BUILDING LINE

STRUCTURAL FILL REQUIRED UNDER PAVEMENT AND FOOTPATHS WHERE CONSTRUCTED ABOVE STRIPPED SURFACE

B	11.04.2025	AS CONSTRUCTED		B.C.	N.G.
A	20.04.2023	ISSUED FOR CONSTRUCTION		B.C.	N.G.
Rev.	Date	Description		Des.	Verif.
					Appd.

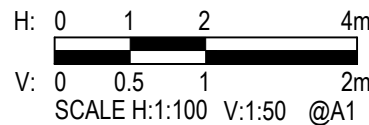

© Cardno Limited All Rights Reserved.
This document is produced by Cardno Limited solely for the benefit of and use by the client in accordance with the terms of the retainer. Cardno Limited does not and shall not assume any responsibility or liability whatsoever to any third party arising out of any use or reliance by third party on the content of this document.



Cardno Victoria Pty Ltd | ABN 47 106 610 913
Level 4, 501 Swanston Street
Melbourne VIC 3000
Tel: 03 8415 7777 Fax: 03 8415 7788
Web: www.cardno.com.au

Drawn	Date
N. WHITE	16.12.2022
Checked	Date
N. GLASSON	11.04.2025
Designed	Date
B. ZHENG	14.12.2022
Verified	Date
N. GLASSON	11.04.2025
Approved	Date
N. GLASSON	11.04.2025

Client	PARKLANE GARDENS DEVELOPMENT PTY LTD	
Project	PARKLANE GARDENS - STAGE 6 504-530 BALLAN ROAD, WYNDHAM VALE WYNDHAM CITY COUNCIL	Status
Title	CIVIL SITEWORKS MADELEINE WAY - SAANICH DRIVE CROSS SECTIONS	A-H Drawing

Status			
AS CONSTRUCTED			
Datum	Melway Ref	Scale	Size
A.H.D.	233 J12	H1:100; V1:50	A1
Drawing Number			Revision
V210926-6-CI-1251			B

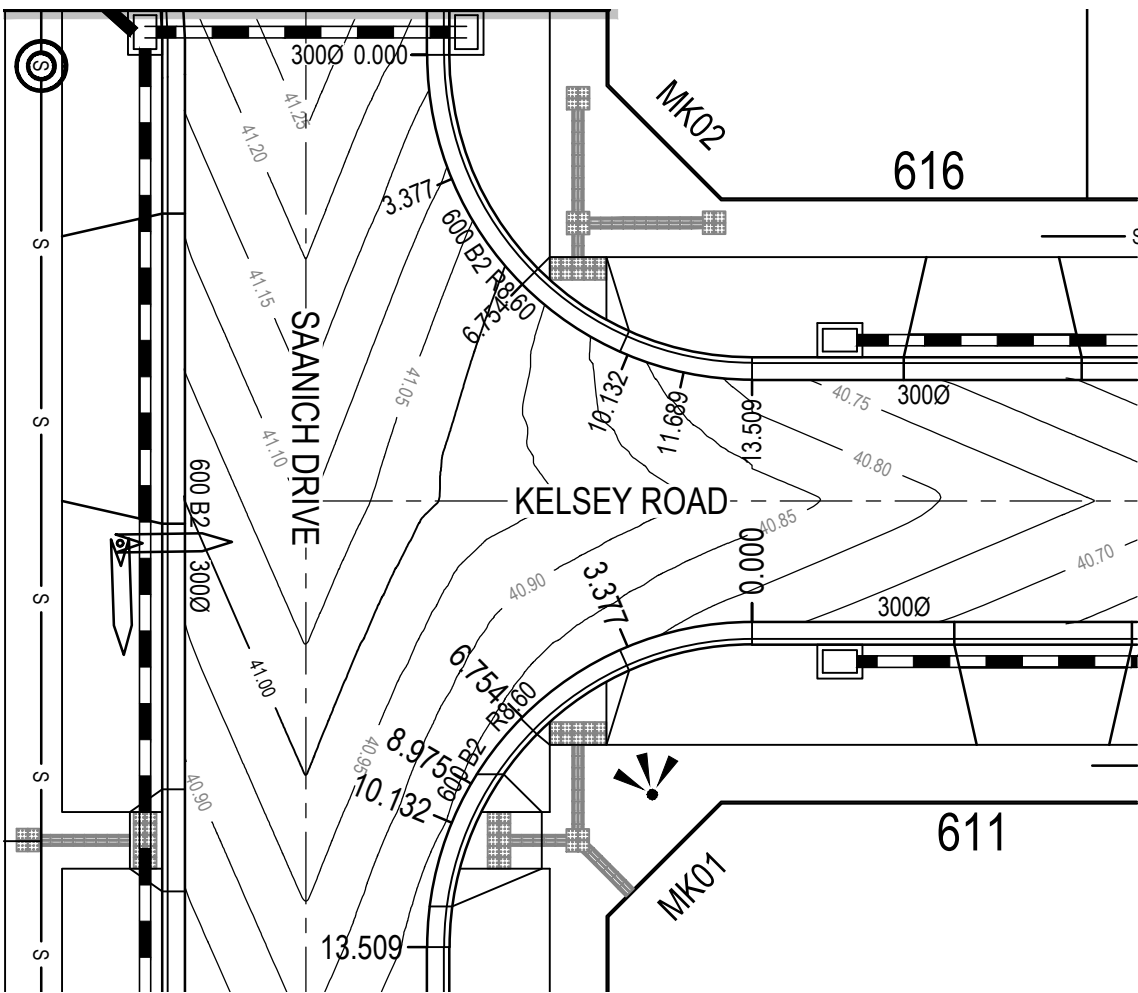

SAANICH DRIVE AND KELSEY ROAD INTERSECTION

SCALE: 1:200

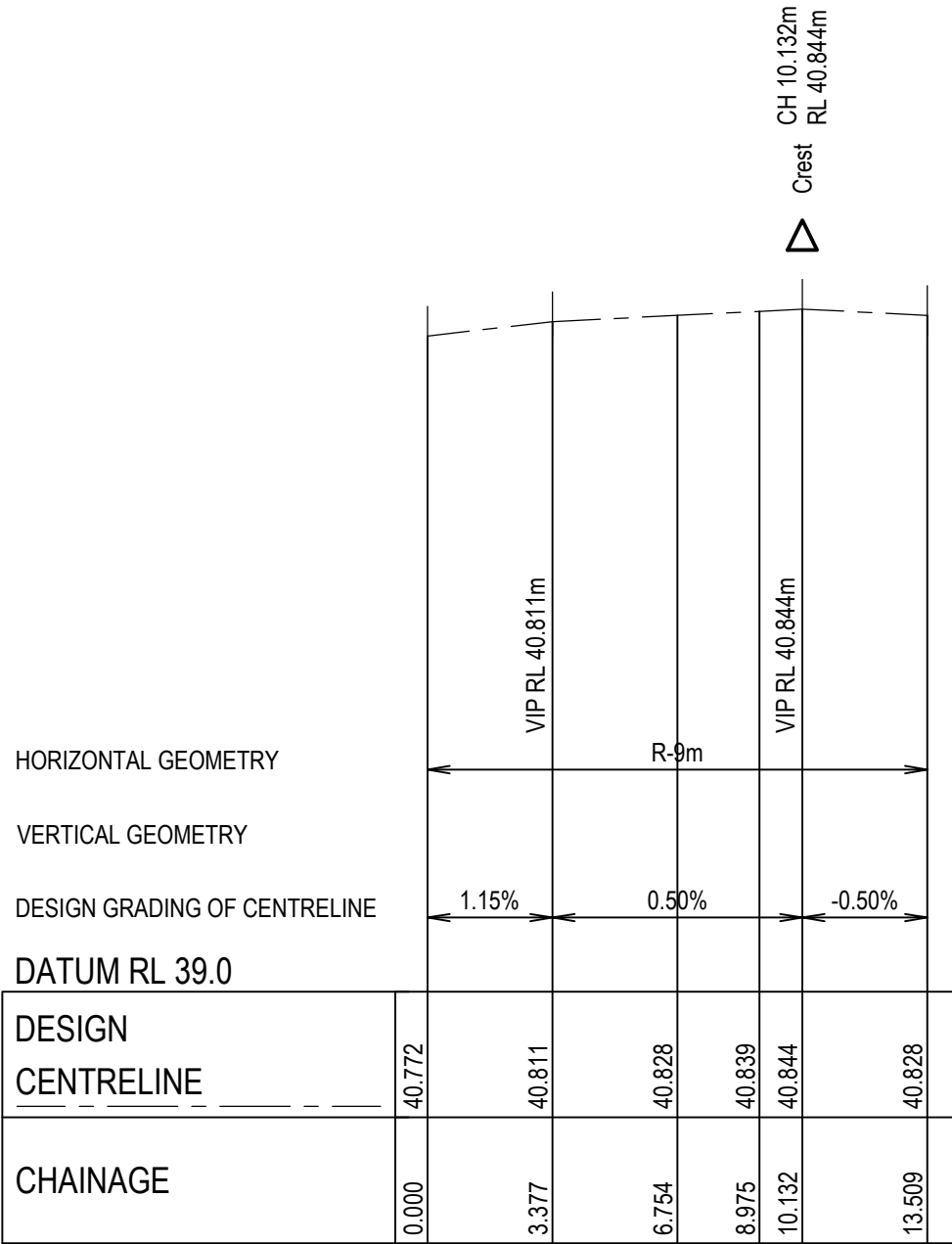

MK01 - LONGITUDINAL SECTION

SCALE: H:1:200; V:1:20

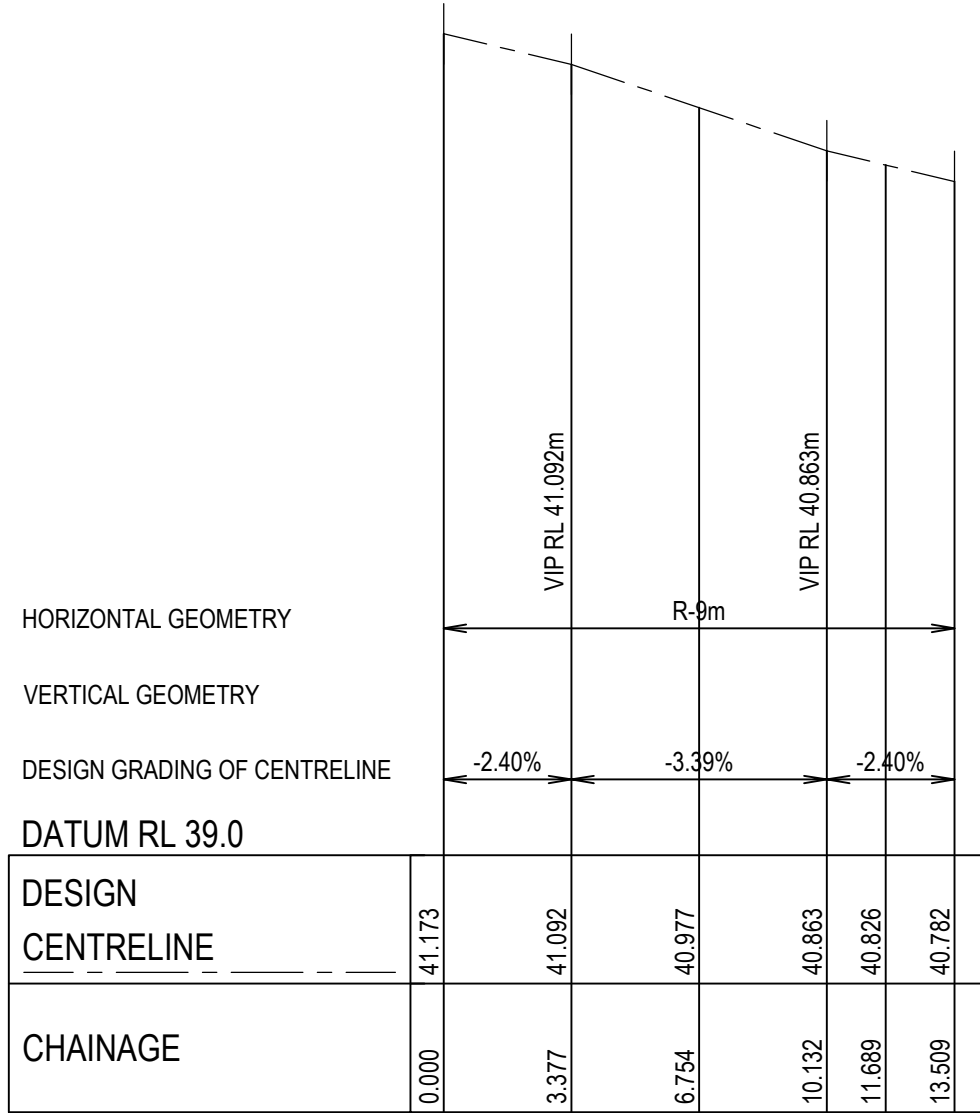

MK02 - LONGITUDINAL SECTION

SCALE: H:1:200; V:1:20

LEGEND	
	DESIGN SURFACE
	FINISHED SURFACE CONTOUR (MAJOR)
	FINISHED SURFACE CONTOUR (MINOR)
	TACTILE GROUND SURFACE INDICATORS
	PROPOSED STORMWATER DRAIN, PIT AND DIAMETER
	EXISTING STORMWATER DRAIN, PIT AND DIAMETER
	PROPOSED AGRICULTURAL DRAIN WITH FLUSH OUT RISER
	PROPOSED SWALE DRAIN
	PROPOSED SEWER, MAINT. STRUCTURES
	EXISTING SEWER, MAINT. STRUCTURES
	PROPOSED BATTER
	KERB AND CHANNEL (AS SHOWN)
	EXISTING FEATURES TO BE REMOVED
	"NO ROAD" SIGN AND BARRIER
	PROPOSED TRAFFIC SIGN
	PROPOSED STREET SIGN
	LINEMARKING AND RRPMS
	PAVEMENT LEVELS
	SAWCUT JOINT
	DOWELLED EXPANSION JOINT
	ISOLATION JOINT
	CONCRETE INFILL
	LANDSCAPING (BY OTHERS)
	EXPOSED AGGREGATE CONCRETE

FOR LINEMARKING AND SIGNAGE DETAILS
REFER TO DRAWING No CI-1400

CONTRACTOR TO VERIFY EXISTING SERVICES
CONNECTION LEVELS PRIOR TO CONSTRUCTION.
ANY DISCREPANCIES MUST BE IMMEDIATELY
IDENTIFIED AND THE SUPERINTENDENT NOTIFIED
PRIOR TO CONSTRUCTION COMMENCING.

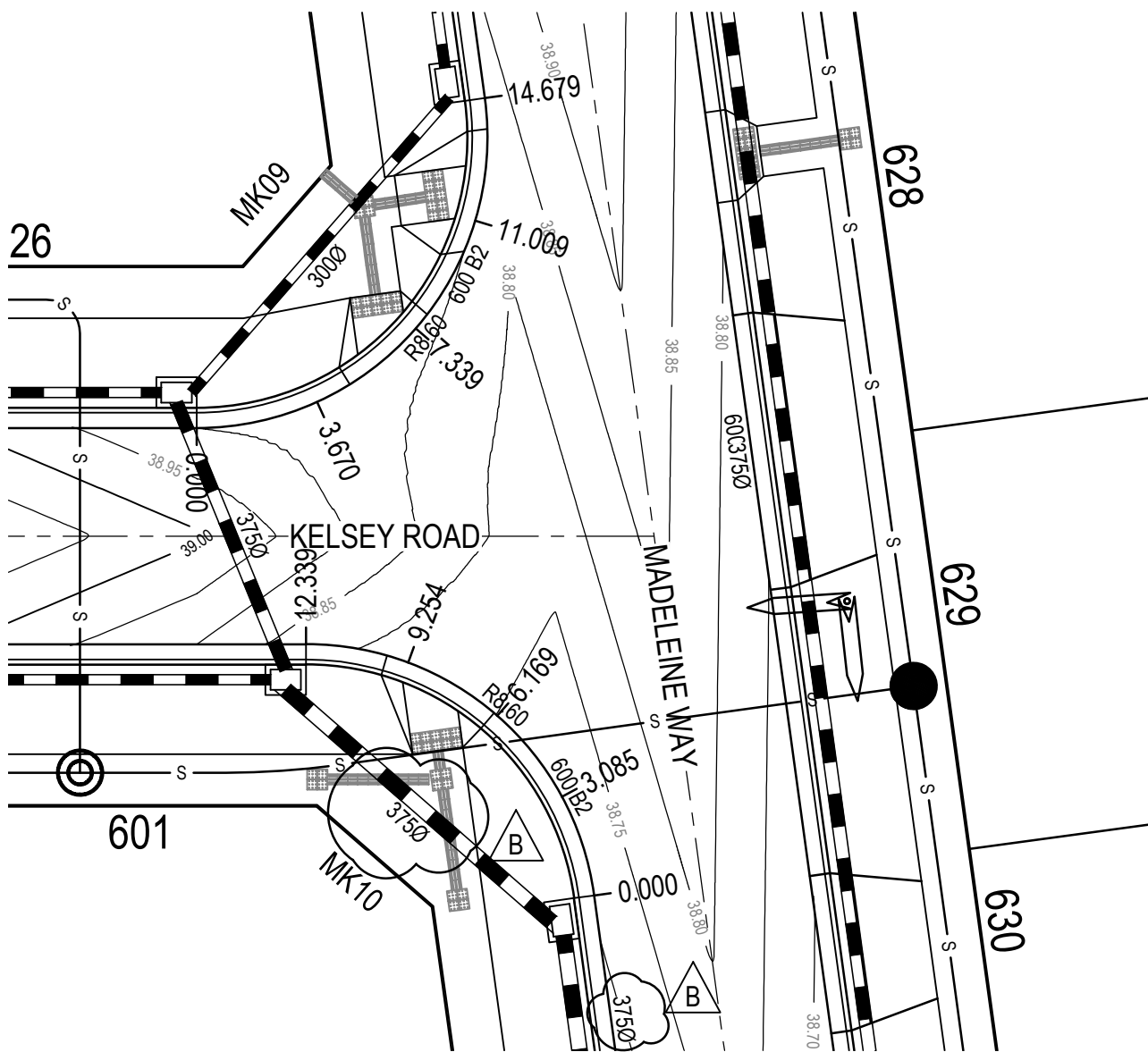

KELSEY ROAD AND MADELEINE WAY INTERSECTION

SCALE: 1:200

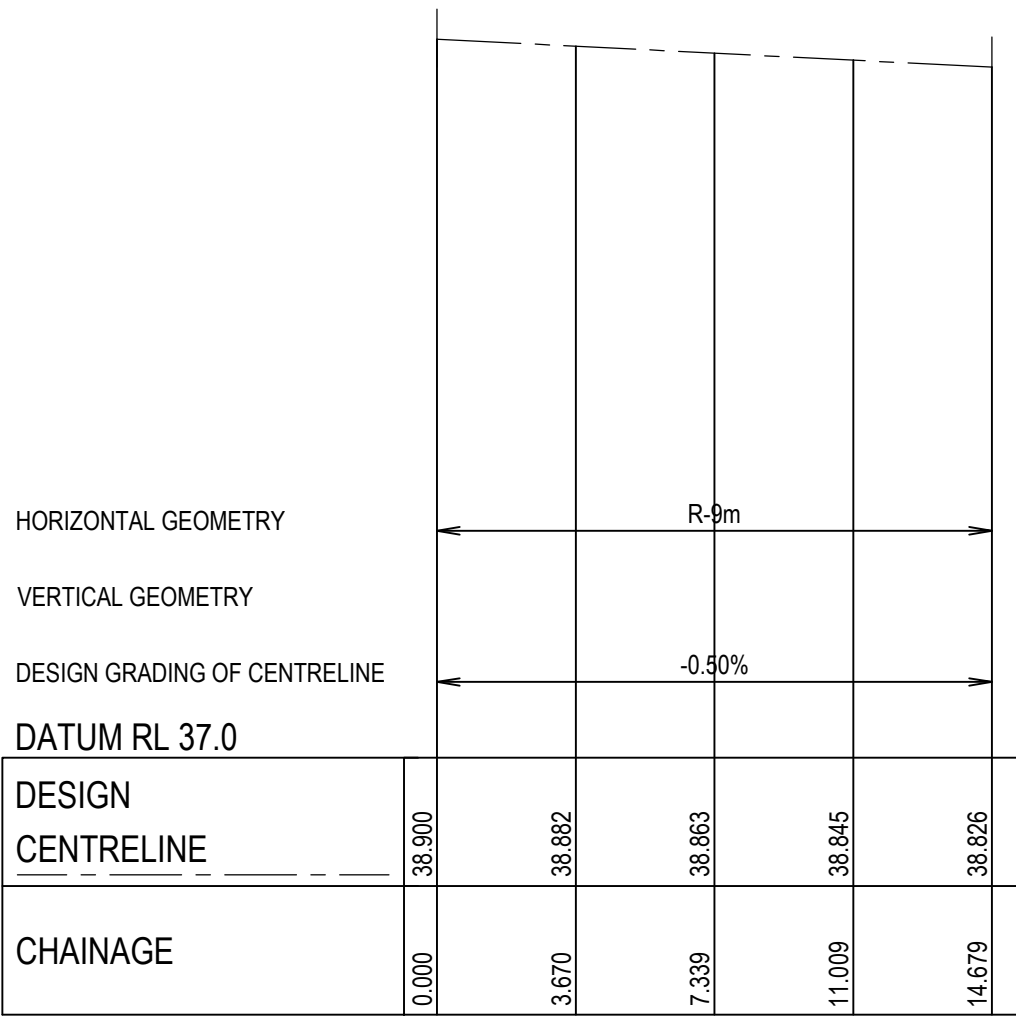

MK09 - LONGITUDINAL SECTION

SCALE: H:1:200; V:1:20

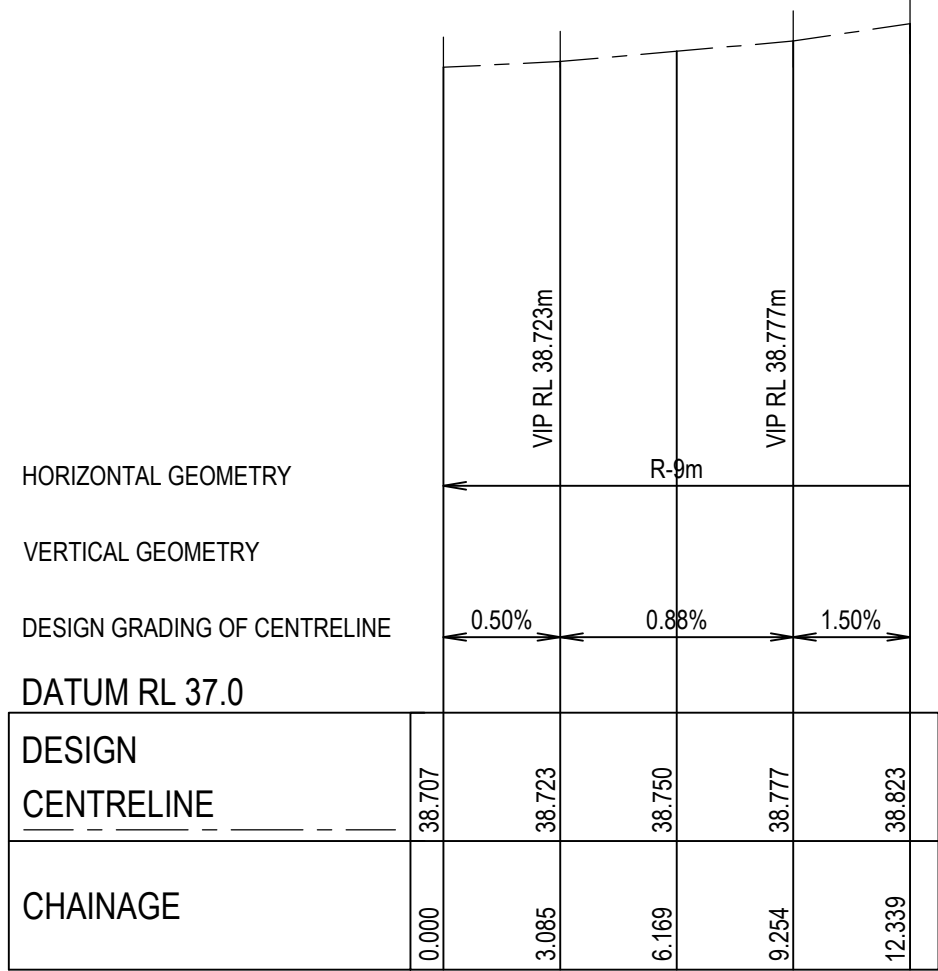

MK10 - LONGITUDINAL SECTION

SCALE: H:1:200; V:1:20

COUNCIL REFERENCE
WYP9651/16

Rev.	Date	Description	Des.	Verif.	Appd.
B	11.04.2025	AS CONSTRUCTED	B.C.	N.G.	N.G.
A	20.04.2023	ISSUED FOR CONSTRUCTION	B.C.	N.G.	N.G.

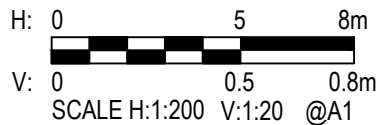
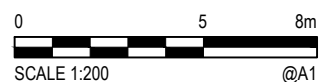

© Cardno Limited All Rights Reserved.
This document is produced by Cardno Limited solely for the benefit of and use by the client in accordance with the terms of the retainer. Cardno Limited does not and shall not assume any responsibility or liability whatsoever to any third party arising out of any use or reliance by third party on the content of this document.



Cardno Victoria Pty Ltd | ABN 47 106 610 913
Level 4, 501 Swanston Street
Melbourne VIC 3000
Tel: 03 8415 7777 Fax: 03 8415 7788
Web: www.cardno.com.au

Drawn N. WHITE	Date 16.12.2022
Checked N. GLASSON	Date 11.04.2025
Designed B. ZHENG	Date 14.12.2022
Verified N. GLASSON	Date 11.04.2025
Approved	Date

Client PARKLANE GARDENS DEVELOPMENT PTY LTD	Project PARKLANE GARDENS - STAGE 6 504-530 BALLAN ROAD, WYNDHAM VALE WYNDHAM CITY COUNCIL	Status AS CONSTRUCTED
Datum A.H.D.	Melway Ref 233 J12	Scale AS SHOWN
Drawing Number V210926-6-CI-1300	Size A1	Revision B

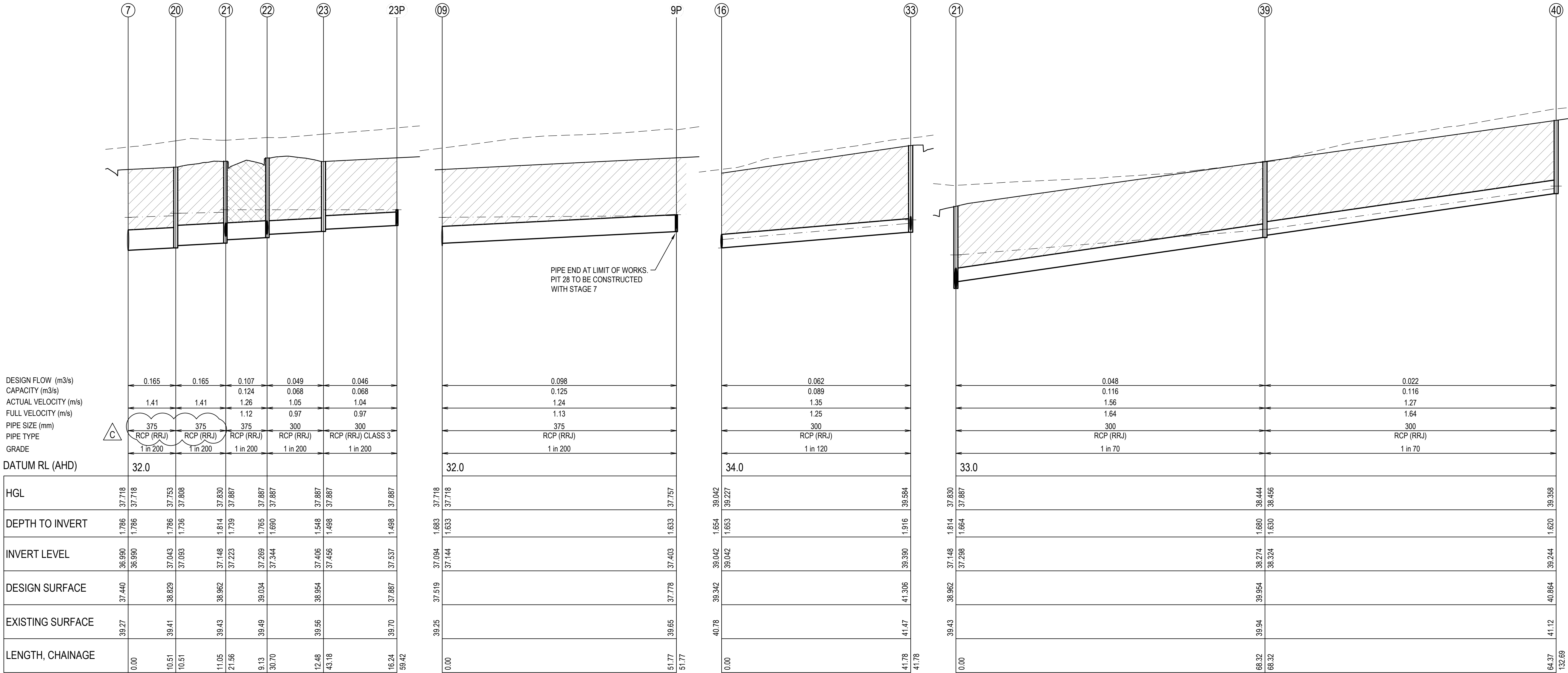

LEGEND

EXISTING SURFACE

DESIGN SURFACE

DRAINAGE HYDRAULIC GRADE LINE (HGL)

PROPOSED DRAINAGE

EXISTING DRAINAGE

PIT NUMBER

PROPERTY INLET INVERT LEVEL

CLASS 3 FINE CRUSHED ROCK BACKFILL

CLASS 2 FINE CRUSHED ROCK BACKFILL

CONTRACTOR TO VERIFY EXISTING SERVICES CONNECTION LEVELS PRIOR TO CONSTRUCTION. ANY DISCREPANCIES MUST BE IMMEDIATELY IDENTIFIED AND THE SUPERINTENDENT NOTIFIED PRIOR TO CONSTRUCTION COMMENCING.

PIPELINES HAVE BEEN DESIGNED TO COMPLY WITH AS/NZS 3725:2007 FOR THE APPROPRIATE EXTERNAL LOAD CLASS DURING CONSTRUCTION ASSUMING THE HAVE A MINIMUM COVER OF 450mm AT ANY POINT; IT IS THE CONTRACTOR'S RESPONSIBILITY TO MAINTAIN THE INTEGRITY OF THE PIPES DURING CONSTRUCTION.

THE CONTRACTOR MUST ENSURE THE PITS AND PIPES ARE FREE DRAINAGE AND GRADE TO THE FUTURE FINISHED SURFACE LEVELS AS SHOWN

Rev.	Date	Description	Des.	Verif.	Appd.
C	11.04.2025	AS CONSTRUCTED	B.C.	N.G.	N.G.
B	12.09.2023	LEGEND UPDATED	B.C.	N.G.	N.G.
A	20.04.2023	ISSUED FOR CONSTRUCTION	B.C.	N.G.	N.G.

© Cardno Limited All Rights Reserved.
This document is produced by Cardno Limited solely for the benefit of and use by the client in accordance with the terms of the retainer. Cardno Limited does not and shall not assume any responsibility or liability whatsoever to any third party arising out of any use or reliance by third party on the content of this document.

Cardno Victoria Pty Ltd | ABN 47 106 610 913
Level 4, 501 Swanston Street
Melbourne VIC 3000
Tel: 03 8415 7777 Fax: 03 8415 7788
Web: www.cardno.com.au

Drawn	N. WHITE	Date	16.12.2022
Checked	N. GLASSON	Date	11.04.2025
Designed	B. ZHENG	Date	14.12.2022
Verified	N. GLASSON	Date	11.04.2025
Approved		Date	

Client	PARKLANE GARDENS DEVELOPMENT PTY LTD
Project	PARKLANE GARDENS - STAGE 6
	504-530 BALLAN ROAD, WYNDHAM VALE
	WYNDHAM CITY COUNCIL
Title	CIVIL SITEWORKS
	DRAINAGE LONGITUDINAL SECTIONS

Status	AS CONSTRUCTED
Datum	A.H.D.
Melway Ref	233 J12
Scale	H1:500; V1:50
Size	A1
Drawing Number	V210926-6-CI-1350
Revision	C

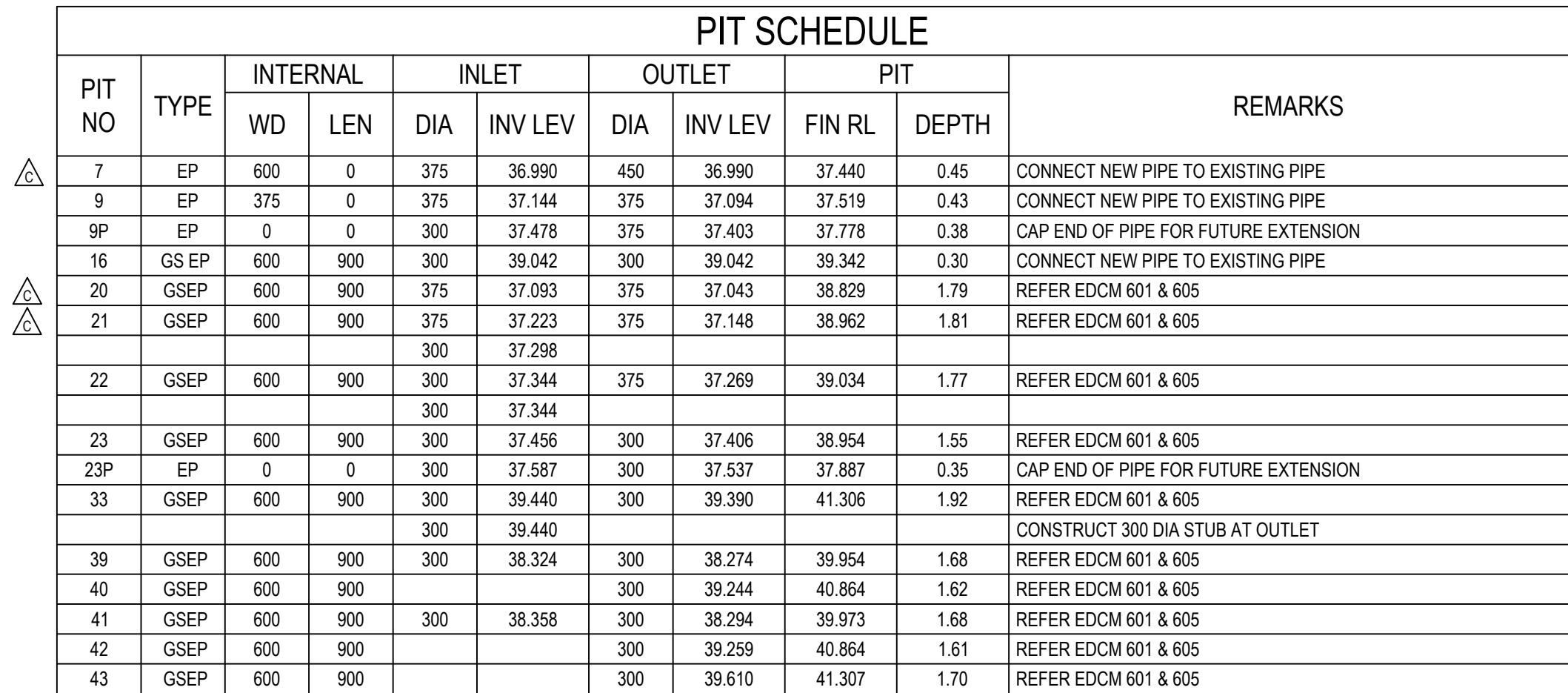

1. ALL PITS ARE TO BE TO VPA STANDARDS UNLESS NOTED OTHERWISE.
2. PITS DEEPER THAN 1.00m SHALL BE FITTED WITH STEPIONS, FIRST STEPION TO BE 300mm FROM THE BOTTOM OF THE PIT.
3. COVER LEVELS TO BE SET TO MATCH THE FINISHED SURFACE PROFILES AND ADJACENT CONSTRUCTION.
4. GP = GRATED PIT, GSEP = GRATED SIDE ENTRY PIT, DGSEP = DOUBLE GRATED SIDE ENTRY PIT, SEP = SIDE ENTRY PIT, DSEP = DOUBLE SIDE ENTRY PIT, JP = JUNCTION PIT, EP = END OF PIPE, GEP = GRATED ENTRY PIT.
5. UNLESS OTHERWISE SPECIFIED, PIT TYPES REFER TO METROPOLITAN PLANNING AUTHORITY STANDARD DRAWINGS
 - EDCM 601 SIDE ENTRY PIT GRATED B2 KERB AND CHANNEL
 - EDCM 602 DOUBLE SIDE ENTRY PIT GRATED 600B2 KERB AND CHANNEL
 - EDCM 605 JUNCTION PIT
6. FOR HAUNCHED PITS REFER VPA STANDARD DRAWING EDCM 607-608 UNLESS NOTED OTHERWISE. LARGE PITS TO BE HAUNCHED TO COUNCIL STANDARD OPENINGS
7. STU AND PIPE ENDS TO BE BLOCKED OFF COUNCIL'S SATISFACTION.
8. ALL GRADED PITS TO HAVE BICYCLE SAFE LOOKDOWN GRATES.
9. ALL GRATED SIDE-ENTRY PITS TO HAVE MIN 150mm THICK CONCRETE APRON BETWEEN GRATE AND ASPHALT. REFER VICROADS SD1322.
10. JUNCTION PITS WITHIN ROAD TO HAVE HEAVY DUTY GATIC OR EQUIVALENT LOCK DOWN LIDS, LID INFILL COLOURED TO MATCH ROAD SURFACE.
11. ALL PITS WITHIN ROAD TO BE CONSTRUCTED WITH 32 MPa CONCRETE WITH SL92 MESH IN WALLS AND BASE.
12. PIT LIDS TO BE GRID-LITE OR TERRA FIRMA (NON-TRAFFICABLE AREAS).
13. ALL PITS IN ROAD RESERVE TO BE FITTED WITH CLASS D COVERS OR GRATES.
14. LEVELS OF ALL EXISTING PIPE INVERTS TO BE CONNECTED TO TO BE CONFIRMED BY SURVEY PRIOR TO CONSTRUCTION.
15. SPLAY PIPE SHOWN ON LONG SECTIONS SHALL BE MANUFACTURED SPLAY PIPES.

THE CONTRACTOR MUST ENSURE THE PITS AND
PIPES ARE FREE DRAINAGE AND GRADE TO THE
FUTURE FINISHED SURFACE LEVELS AS SHOWN

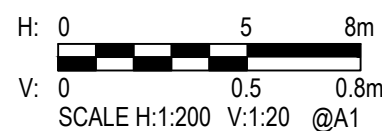
[illegible]

wes gault
wes@gault.net.au
0408 692 443

gault+

projects through partnerships

© Cardno Limited All Rights Reserved.
This document is produced by Cardno Limited solely for the benefit of and use by the client in accordance with the terms of the retainer. Cardno Limited does not and shall not assume any responsibility or liability whatsoever to any third party arising out of any use or reliance by third party on the content of this document.

 **Cardno®**

Cardno Victoria Pty Ltd | ABN 47 106 610 913
Level 4, 501 Swanston Street
Melbourne VIC 3000
Tel: 03 8415 7777 Fax: 03 8415 7788
Web: www.cardno.com.au

Drawn N. WHITE	Date 16.12.2022	Client PARKLANE GARDENS DEVELOPMENT PTY LTD				
Checked N. GLASSON	Date 11.04.2025	Project PARKLANE GARDENS - STAGE 6 504-530 BALLAN ROAD, WYNDHAM VALE WYNDHAM CITY COUNCIL	Status AS CONSTRUCTED			
Designed B. ZHENG	Date 14.12.2022		Date A.H.D.	Melway Ref 233 J12	Scale H1:500; V1:50	Size A1
Verified N. GLASSON	Date 11.04.2025		Drawing Number V210926-6-CI-1351		Revision C	
Approved	Date		Title CIVIL SITEWORKS DRAINAGE LONGITUDINAL SECTIONS AND PIT SCHEDULE			
N. GLASSON	11.04.2025					

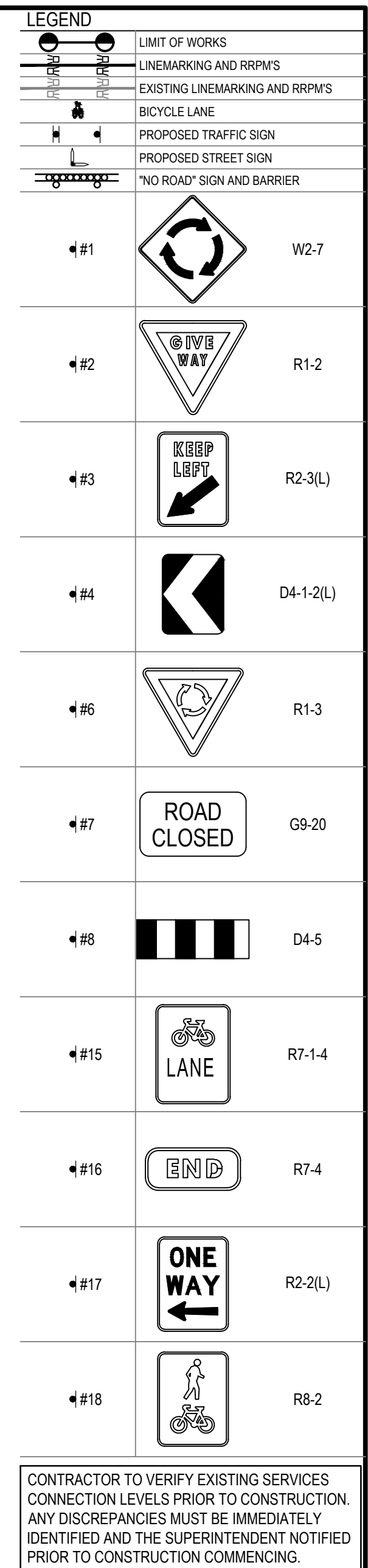

CONTRACTOR TO VERIFY EXISTING SERVICES
CONNECTION LEVELS PRIOR TO CONSTRUCTION.
ANY DISCREPANCIES MUST BE IMMEDIATELY
IDENTIFIED AND THE SUPERINTENDENT NOTIFIED
PRIOR TO CONSTRUCTION COMMENCING.

COUNCIL REFERENCE
WYP9651/16

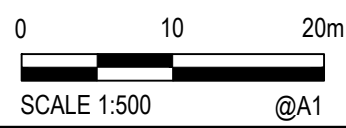

projects through partnerships.

© Cardno Limited All Rights Reserved.
This document is produced by Cardno Limited solely for the benefit of and use by the client in accordance with the terms of the retainer. Cardno Limited does not and shall not assume any responsibility or liability whatsoever to any third party arising out of any use or reliance by third party on the content of this document.



Client	PARKLANE GARDENS DEVELOPMENT PT
Project	PARKLANE GARDENS - STAGE 6 504-530 BALLAN ROAD, WYNDHAM VALE WYNDHAM CITY COUNCIL
Title	CIVIL SITEWORKS SIGNAGE AND LINEMARKING PLAN AND LOT DIMENSIONS

Status	AS CONSTRUCTED
--------	----------------

Datum	Melway Ref	Scale	Size
A.H.D.	233 J12	1:500	A1
Drawing Number			Revision
V210926-6-CI-1400			B